

End Semester Examination, May 2023

B. Sc. (Interior Design) - First Semester

COMMUNICATION - I (351.107/351.107A)

Time: 3 hrs.

Max. Marks: **100**

No. of pages: 1

Note: Attempt **FIVE** questions in all; **Q.1 is compulsory**. Attempt any **TWO** questions from **PART-A** and **TWO** questions from **PART-B**. Each question carries equal marks.

Q.1 Answer the following in brief:

- a) What are the barriers to communication?
- b) What are 7 C's of communication.
- c) What is self-awareness? How to develop self-awareness?
- d) Describe 'grooming'.
- e) Explain inter-cultural communication with an example.

4×5

PART-A

Q.2 What do you understand by SWOT? Explain with your self-assessment. **20**

Q.3 What is personality development? How to bring out the best in one's personality? **20**

Q.4 Write your Self introduction. **20**

PART-B

Q.5 Write a letter to your HOD to allow you to attend pre-placement crash course on 28/06/2023 in your college. **20**

Q.6 What are the smart goals? Why should we set goals? Explain five principles of goal setting. **20**

Q.7 Write a letter to your society secretary complaining about the garbage collection problem in your tower. **20**

End Semester Examination, May 2023

B. Sc. (Interior Design) - First Semester

MATERIAL AND FINISHES - I (351.108)

Time: 3 hrs.

Max. Marks: **40**

No. of pages: **1**

Note: Attempt **FIVE** questions in all; **Q.1 is compulsory**. Attempt any **TWO** questions from **PART-A** and **TWO** questions from **PART-B**. Each question carries equal marks.

- Q.1 Describe briefly:
- a) Radiant heat flooring.
 - b) Engineered wood.
 - c) VOC.
 - d) Budget estimate.

[CO-1][L-1] **2×4**

PART-A

- Q.2 Explain about various materials used in flooring.

[CO-2][L-2] **8**

- Q.3 Discuss the characteristics of any two floor covering materials with their end use application.

[CO-3][L-3] **8**

- Q.4 Recommend materials that will make less of an impact on our environment and are made from renewable resources.

[CO-4][L-4] **8**

PART-B

- Q.5 Explain the performance, properties and application of any four different materials.

[CO-5][L-5] **8**

- Q.6 Write about the types of wall covering materials with their application process.

[CO-5][L-5] **8**

- Q.7 Explain in detail the three steps in the process of transforming a skin into a piece of leather.

[CO-1][L-1] **8**

End Semester Examination, May 2023
B. Sc. (Interior Design) — First Semester
DESIGN ELEMENTS AND PRINCIPLE OF OUR ENVIRONMENT
(351.109A)

Time: 3 hrs.

Max Marks: **50**

No. of pages: **1**

Note: Attempt **FIVE** questions in all; **Q.1** is **compulsory**. Attempt any **TWO** questions from **PART-A** and **TWO** questions from **PART-B**. Marks are indicated against each question.

Q.1 Describe the following:

- a) Emphasis.
- b) Proportion.
- c) Harmony.
- d) Rhythm.
- e) Balance.

2×5

PART-A

Q.2 What are the elements of design? Explain with illustrations. [CO1] [L1] **10**

Q.3 Explain Gestalt principles in detail with sketches.
Draw a composition using any one of the laws of Gestalt theory. [CO2] [L2] **10**

Q.4 Define the relationship between multi-cultural life and urban design. [CO2] [L5] **10**

PART-B

Q.5 Form is an essential element of design, comment (250 words). [CO2] [L2] **10**

Q.6 Explain a principle of design (with a sketch) that artists use to create visual weight. [CO3] [L3] **10**

Q.7 Explain different ways to create rhythm in design. Support with suitable illustrations. [CO4] [L6] **10**

End Semester Examination, May 2023

B. Sc. (Interior Design) — Third Semester

LIGHTING (351.305A)

Time: 3 hrs.

Max Marks: **50**

No. of pages: **1**

Note: Attempt **FIVE** questions in all; **Q.1** is **compulsory**. Attempt any **TWO** questions from **PART-A** and **TWO** questions from **PART-B**. Marks are indicated against each question.

Q.1 What is light? Explain the lighting sources of light. [CO2] [L2] **10**

PART-A

Q.2 What is the difference between Ambient, Accent and task light? **10**

Q.3 Write a short note on the following:
Portable Light, Warm Lights, Luminaires, Cool Lights, Fixed Light. [CO2] [L2] **10**

Q.4 What is the difference between luminaires and lighting fixtures? [CO3] [L3] **10**

PART-B

Q.5 What is the importance of lighting in interior design? Why do we make a lighting plan? [CO4] [L4] **10**

Q.6 Write short notes on the following:
Yard Light, Bollard Lamp, High Mast Lamp, Recessed Light, Ceiling Dome. [CO5] [L5] **10**

Q.7 What is lighting control system? Explain the different types of light controls? [CO6] [L6] **10**

End Semester Examination, May 2023
B. Sc. (Interior Design) — Third Semester
MARKETING TECHNIQUES (351.307B)

Time: 3 hrs.

Max Marks: **50**

No. of pages: **1**

Note: Attempt **FIVE** questions in all; **Q.1** is **compulsory**. Attempt any **TWO** questions from **PART-A** and **TWO** questions from **PART-B**. Marks are indicated against each question.

Q.1 Define the following (**any five**):

- a) Sales Channel.
- b) Customer.
- c) Positioning.
- d) Marketing Mix.
- e) Niche Marketing.
- f) Business Plan.

2×5

PART-A

- Q.2 Define the term: Marketing. Explain the different stages of marketing research in detail.
[CO1] [L1] **10**
- Q.3 What is segmentation? How can you segment a market for an interior design firm? Discuss in detail.
[CO2] [L2] **10**
- Q.4 Discuss HR and its role. Explain the HR agenda that should be incorporated by a start-up company.
[CO3] [L3] **10**

PART-B

- Q.5 Illustrate the various strategies for business development.
[CO4] [L4] **10**
- Q.6 Define 'FAB'. Justify through examples how can FAB be used to improve sales?
[CO5] [L5] **10**
- Q.7 Elaborate market segmentation on the basis of geographical and behavioural aspects.
[CO6] [L6] **10**

End Semester Examination, May 2023

B. Sc. (Interior Design) – Fourth Semester

MARKETING TECHNIQUES (351.307B)

Time: 3 hrs.

Max Marks: **50**

No. of pages: 1

Note: Attempt **FIVE** questions in all; **Q.1 is compulsory**. Attempt any **TWO** questions from **PART-A** and **TWO** questions from **PART-B**. Marks are indicated against each question.

- Q.1 What is segmentation? How can you segment a market for an interior design firm? Discuss in detail. **10**

PART-A

- Q.2 Define the term 'Advertisement'. Discuss in detail advertising strategy. [CO-1][L-1] **10**

- Q.3 Define 'selling process'. Describe lead generating method. [CO- 2] [L-2] **10**

- Q.4 Define the following terms:

- a) Marketing mix.
- b) Know your customer.
- c) Sales channels.
- d) Costs.
- e) Niche market.

[CO-3][L-3] **2×5**

PART-B

- Q.5 Define the term "Marketing". Explain the different stages of marketing research. [CO-4] [L-4] **10**

- Q.6 List out all the stages of new product development. Explain any one stage in detail relating the same with interior design. [CO-5] [L-5] **10**

- Q.7 Elaborate (**any two**) of the following on the basis of market segmentation:

- a) Behavioral.
- b) Geographical.
- c) Socio-cultural.
- d) Demographical.

[CO-6] [L-6] **5×2**

End Semester Examination, May 2023

B. Sc. (Interior Design) - Fourth Semester

LIVING GREEN (351.309B)

Time: 3 hrs.

Max Marks: **50**

No. of pages: **1**

Note: Attempt **FIVE** questions in all; **Q.1 is compulsory**. Attempt any **TWO** questions from **PART-A** and **TWO** questions from **PART-B**. Marks are indicated against each question.

Q.1 Describe the ethical challenges associated with climate change. [CO-1] [L-1] **10**

PART-A

Q.2 Explain the steps individuals can take to reduce their impact on the environment. [CO.1][L-2] **10**

Q.3 Elaborate on the ways to maintain indoor air quality in a home. Write few examples. [CO.2][L-2] **10**

Q.4 What does it mean to be a green consumer? Explain in detail. [CO.3][L-1] **10**

PART-B

Q.5 Write a brief on sustainable materials that can be used in interior design [CO.4][L-4] **10**

Q.6 What are the ways to reduce heating cost in a home? [CO.5][L-5] **10**

Q.7 What are the strategies to reduce fuel consumption, explain with alternatives. [CO.6][L-6] **10**

End Semester Examination, May 2023

B. Sc. (Interior Design) — Third Semester

DESIGN THINKING (351.310A)

Time: 3 hrs.

Max Marks: **50**

No. of pages: **1**

Note: Attempt **FIVE** questions in all; **Q.1** is **compulsory**. Attempt any **TWO** questions from **PART-A** and **TWO** questions from **PART-B**. Marks are indicated against each question.

- Q.1 Explain in detail about the empathise stage in design thinking. What is the process to achieve this stage? Also, draft a sample of empathy maps to support your answer. [CO1] [L1] **10**

PART-A

- Q.2 Write in detail about the process of design thinking. Explain how design thinking process helps an interior designer in designing and execution of a project. [CO3] [L2] **10**
- Q.3 Describe the stage of prototyping in design thinking. Write short notes on:
a) Low-fidelity prototyping.
b) High-fidelity prototyping. [CO5] [L2] **5×2**
- Q.4 Design thinking is an iterative and non-linear process. It is a problem-solving approach that has the intention to improve the end product. Justify the statement. [CO4] [L2] **10**

PART-B

- Q.5 What are the various types of creativity? Mention any two theories of creativity. [CO2] [L1] **10**
- Q.6 Discuss the importance of brainstorming design thinking process. Support your answer with suitable examples. [CO2] [L2] **10**
- Q.7 Prepare a framework of complete design thinking process for a proposed project (from conceptualization to final output) with the help of an example of an interior design space. Sketch bubble diagrams wherever required. [CO6] [L1] **10**

End Semester Examination, May 2023
B. Sc. (Interior Design) — Third Semester
BUSINESS SKILL FOR DECORATORS (351.401B)

Time: 3 hrs.

Max Marks: **50**

No. of pages: **1**

Note: Attempt **FIVE** questions in all; **Q.1** is **compulsory**. Attempt any **TWO** questions from **PART-A** and **TWO** questions from **PART-B**. Marks are indicated against each question.

- Q.1 List down 10 roles of interiors and their applications in the context of buildings. **10**

PART-A

- Q.2 What are the various scope of work for interior designers? Name any five in depth.
[CO1] [L1] **10**

- Q.3 List any five characteristics of indoor space which is the criteria for different solution in interior designing/decoration.
[CO2] [L2] **10**

- Q.4 What are the various principles of composition of visual elements which are used in modulation of interior spaces?
[CO3] [L3] **10**

PART-B

- Q.5 What do you understand by barrier free design? List any five in context to furniture design.
[CO4] [L4] **10**

- Q.6 How can we design interior space for efficient use of lighting and cooling? List 10 provisions for the same.
[CO5] [L5] **10**

- Q.7 List various elements of interior landscape design. Explain methods of application for any two.
[CO6] [L6] **10**

End Semester Examination, May 2023
B. Sc. (Interior Design) – Sixth Semester
PROFESSIONAL PRACTICE AND PROJECT REPORT PRESENTATION
(351.611A)

Time: 2 hrs.

Max Marks: **50**

No. of pages: **1**

Note: Attempt **FIVE** questions in all; **Q.1 is compulsory**. Attempt any **TWO** questions from **PART-A** and **TWO** questions from **PART-B**. Marks are indicated against each question.

Q.1 Write short notes on **(any five)** of the following:

- a) Contract.
- b) Arbitration.
- c) Ethics and values.
- d) Tender notice.
- e) Specifications.
- f) Bill of quantities.

2×5

PART-A

Q.2 What is the role of an interior designer towards the execution of a project? [CO-1] [L-5] **10**

Q.3 Who is an interior designer? Discuss an interior designer's SCOPE OF WORK for residential design. [CO-2] [L-2] **10**

Q.4 Discuss the importance of research and case studies in interior design. Explain in detail. [CO-3] [L-4] **10**

PART-B

Q.5 What is "item rate or unit price" contract? Explain its nature of argument, mode of payment, advantages and limitations. [CO-4] [L-3] **10**

Q.6 How will an interior designer promote their business? State various ways and means of promotion in detail and justify your answer. [CO-5] [L-6] **10**

Q.7 Discuss in detail **(any two)**:

- a) Agreement.
- b) Estimate.
- c) Third party in contract.

[CO-2] [L-1] **5×2**

End Semester Examination, May 2023
Bachelor of Architecture — First Semester
SURVEYING AND LEVELLING - I (AR-110)

Time: 3 hrs.

Max Marks: **40**

No. of pages: **1**

Note: Attempt **FIVE** questions in all; **Q.1** is **compulsory**. Attempt any **TWO** questions from **PART-A** and **TWO** questions from **PART-B**. Marks are indicated against each question.

- Q.1 Answer the following in brief:
- a) What do you understand by the term "surveying"? [CO1] [L2]
 - b) Compare "land surveying" and "hydrographic surveying". [CO1] [L2]
 - c) What do you understand by "curvature coefficient"? [CO1] [L2]
 - d) Define "representative fraction". [CO1] [L1]
 - e) Elaborate "plain scale" in context with (napping. [CO1] [L2]
 - f) Distinguish between "gunter's chain" and "engineer's chain". [CO1] [L2]
 - g) Justify the significance of levelling. [CO1] [L1]
 - h) Summarize the importance of remote sensing in data collection. [CO1] [L2]
 - i) Convert $48^{\text{hrs}} 37^{\text{min}} 23^{\text{sec}}$ into angles. [CO1] [L3]
 - j) Describe "traverse surveying". [CO1] [L2] **1×10**

PART-A

- Q.2 If the length of a line measured is 1300 m by using a 30 m chain, it was observed that length of the chain used isn't correct. Determine the actual length of the line considered if the actual length of the chain is
- a) 30.5 m and
 - b) 29.3 m
- [CO1] [L4] **8**
- Q.3 With the help of neat sketches, elaborate different types of scales used in surveying and levelling. [CO1] [L3] **8**
- Q.4 Write a well - detailed note on fundamental principles of plane surveying. [CO1] [L2] **8**

PART-B

- Q.5 Explain in detail the three principal methods of levelling. [CO1] [L2] **7**
- Q.6 With the help of neat sketches, compare "whole circle bearing system" and "quadrantal system of bearing". [CO1] [L3] **7**
- Q.7 Enlighten the significance of remote sensing and CIS in surveying and levelling. [CO1] [L2] **7**

End Semester Examination, May 2023

Bachelor of Architecture – Second Semester

STRUCTURAL DESIGN-II (AR-205)

Time: 3 hrs.

Max Marks: **70**

No. of pages: **1**

Note: Attempt **FIVE** questions in all; **Q.1 is compulsory**. Attempt any **TWO** questions from **PART-A** and **TWO** questions from **PART-B**. Marks are indicated against each question.

- Q.1 a) State the various assumptions considered in determination of Strength of Materials? [CO-1][L-1]
b) Define "Hooke's Law". [CO-2][L-3]
c) With the help of a neat sketch, illustrate "Shear Stresses". [CO-3][L-2]
d) Differentiate between "Sagging Moment" and "Hogging Moment". [CO-4][L-1]
e) Elaborate the term "Trusses". [CO-6] [L-1] **2×5**

PART-A

- Q.2 With the help of a neat sketch, illustrate the Stress – Strain curve for Mild Steel. [CO-1] [L-3] **15**
- Q.3 Plan a mechanism to develop the relation between three Coefficients of Elasticity. [CO-2] [L-5] **15**
- Q.4 With the help of neat sketches, summarize different types of beams and their behavior in terms of reactions, under the action of Point Load and Concentrated Load. [CO-3] [L-3] **15**

PART-B

- Q.5 With the help of neat sketch, plan a mechanism to determine maximum shear force and maximum bending moment for a simply supported beam subjected to uniformly distributed load "w kN/m" over its entire span 'l'. [CO-4] [L-3] **15**
- Q.6 Evaluate Maximum Bending Moment for a Fixed Beam ABCD, with AB = BC = CD = 5m, Point Load of 10 kN acting at B and Udl of 15 kN/m on CD. [CO-5] [L-4] **15**
- Q.7 Correlate the difference between "Method of Joint" and "Method of Section" with Trusses. [CO-6] [L-4] **15**

End Semester Examination, May 2023
Bachelor of Architecture — Second Semester
SOCIOLOGY AND PSYCHOLOGY OF ARCHITECTURE (AR-207A)

Time: 3 hrs.

Max Marks: **40**

No. of pages: **1**

Note: Attempt **FIVE** questions in all; **Q.1** is **compulsory**. Attempt any **TWO** questions from **PART-A** and **TWO** questions from **PART-B**. Marks are indicated against each question.

Q.1 Explain the impact of sociology in architecture over the time period. **8**

PART-A

Q.2 Describe Sociology and areas of sociology. [CO1] [L1] **8**

Q.3 Discuss the concept of society. Also, explain its types and its characteristics. [CO2] [L2] **8**

Q.4 Determine the various types of social interactions and their significance. [CO3] [L3] **8**

PART-B

Q.5 What is the relationship between psychology and spatial behavior? [CO4] [L4] **8**

Q.6 Compare various types of territorial spaces? Also, define the term territorial spaces. [CO5] [L5] **8**

Q.7 Describe Lunch's theory of cognitive patterns. [CO6] [L6] **8**

End Semester Examination, May 2023
Bachelor of Architecture — Third Semester
HISTORY OF ARCHITECTURE-I (AR-304A)

Time: 3 hrs.

Max Marks: **40**

No. of pages: **1**

Note: Attempt **FIVE** questions in all; **Q.1** is **compulsory**. Attempt any **TWO** questions from **PART-A** and **TWO** questions from **PART-B**. Marks are indicated against each question.

- Q.1 Discuss in brief about the prehistoric period. Also, state the major differences between Paleolithic Settlements and Neolithic Settlements with examples. [CO1] [L1] **8**

PART-A

- Q.2 Explain the architectural style of river valley civilizations. Describe the salient architectural features of Indus Valley Civilizations through appropriate examples. **8**

- Q.3 Explain in detail the evolution of Egyptian civilization and its architectural features. [CO2] [L2] **8**

- Q.4 Mention the special characteristics features of all the periods of Greek Architecture. Explain the column orders and proportion in detail with sketches. [CO5] [L5] **8**

PART-B

- Q.5 What were the major architecture principles behind planning of Roman ancient towns? Discuss the Roman style features with some major examples. [CO6] [L4] **8**

- Q.6 What were the salient features of the Chinese architectural style? Describe the building typologies. [CO4] [L4] **8**

- Q.7 Explain the architectural character followed in the earlier Mesopotamian period. Also, explain in detail the Ziggurat of Ur and Ziggurat of Ur-Nammu. [CO3] [L3] **8**

End Semester Examination, May 2023
Bachelor of Architecture — Third Semester
STRUCTURAL DESIGN-III (AR-305A)

Time: 3 hrs.

Max Marks: **40**

No. of pages: **1**

Note: Attempt **FIVE** questions in all; **Q.1** is **compulsory**. Attempt any **TWO** questions from **PART-A** and **TWO** questions from **PART-B**. Marks are indicated against each question.

- Q.1 Answer the following in brief:
- a) Define "theory of composites". [CO1] [L1]
 - b) Summarize the various properties of a typical composite beams. [CO2] [L1]
 - c) State "theory of simple bending". [CO3] [L2]
 - d) What do you understand by the term "OPC 43"? [CO4] [L1]
 - e) Justify the importance of "slenderness ratio" in structural design [CO5] [L2] **2×5**

PART-A

- Q.2 A steel beam 120 mm wide and 130 mm deep is simply supported over a span of 10 m. If shear force at a section of the beam is 4 kN, find the shear stress at a distance of 20 mm above the neutral axis. [CO1] [L4] **7**
- Q.3 A beam of uniform rectangular section 220 mm wide and 350 mm deep is fixed at its ends. It carries a uniformly distributed load of 10 kN/m run over entire span of 8 m. If the value of E for the beam material is 2×10^4 N/mm², evaluate maximum deflection. [CO2] [L5] **7**
- Q.4 Justify the application of "three moment theorem" in the analysis of a typical continuous simply supported beam ABC. [CO3] [L4] **7**

PART-B

- Q.5 With fixed beam AB of length 5m carries a point load of 40kN at a distance of 2m from:
- a) If the flexural rigidity (i.e., EI) of the beam is 0.5×10^4 kNm². Using slope and deflection method, evaluate:
 - i) Fixed end moments at A and B.
 - ii) Deflection under the load.
 - iii) Maximum deflection. [CO4] [L4] **8**
- Q.6 Write a well - explanatory note on "effective length of column" as per the guidelines of IS 456: 2000. [CO5] [L3] **8**
- Q.7 Summarize the different properties of aggregates considered while performing the operation of mix designing of concrete. [CO6] [L3] **8**

End Semester Examination, May 2023
Bachelor of Architecture — Third Semester
SURVEYING AND LEVELLING (AR-306)

Time: 3 hrs.

Max Marks: **100**

No. of pages: **1**

Note: Attempt **FIVE** questions in all; **Q.1** is **compulsory**. Attempt any **TWO** questions from **PART-A** and **TWO** questions from **PART-B**. Marks are indicated against each question.

- Q.1 Answer the following in brief:
- a) Define 'surveying'.
 - b) State the principle of surveying.
 - c) What are source of errors?
 - d) Define the terms: 'bearing'.
 - e) Why magnetic declination happens. What are the types?
 - f) Mention the classifications of Bench Mark.
 - g) Relate reduced level and datum surface.
 - h) Write the classification of theodolites.
 - i) State the concept of DGPS.
 - j) Write the types of remote sensing.

2×10

PART-A

- Q.2 Describe in detail about the classification of surveying. [CO1] [L1] **20**
- Q.3 a) What are the instrument and accessories used for a chain survey? Explain the functions of each with neat sketch.
b) Explain about errors and obstacles in chain surveying. [CO1] [L2] **10×2**
- Q.4 a) Explain radiation method of plane tabling. [CO1] [L2] **10**
b) Define the following terms:
i) Vertical axis.
ii) Horizontal axis.
iii) Line of sight/line of collimation.
iv) Axis of level tube. [CO1] [L2] **2½×4**

PART-B

- Q.5 The following staff readings were observed successively with a level the instrument having been moved after third, sixth and eight readings.
2.228, 1.606, 0.988, 2.090, 2.864, 1.262, 0.602, 1.982, 1.044, 2.684 m. Enter the above readings in a level book and calculate the RL of points. The elevation of BM is 432.384m. [CO1] [L3] **20**
- Q.6 Explain in detail about methods of contouring also mention the characteristics of contour line. [CO1] [L2] **20**
- Q.7 a) Explain in detail about the process and applications of DGPS modeling.
b) List out the applications of remote sensing and GIS in detail. [CO1] [L2] **10×2**

End Semester Examination, May 2023
Bachelor of Architecture — Third Semester
THEORIES IN ARCHITECTURE AND DESIGN-I (AR-307)

Time: 3 hrs.

Max Marks: **60**

No. of pages: **1**

Note: Attempt **FIVE** questions in all; **Q.1** is **compulsory**. Attempt any **TWO** questions from **PART-A** and **TWO** questions from **PART-B**. Marks are indicated against each question.

- Q.1 Describe the timeline of architectural movements and explain the characteristics of any two movements. Support your answers with sketches. **20**

PART-A

- Q.2 Discuss the works and ideologies of **any two** of the following:
a) Frank Lloyd Wright.
b) Walter Gropius.
c) Mies Van Der Rohe. [CO4] [L2] **5×2**
- Q.3 Explain "Deconstructivism" in architecture in the light of postmodernism. [CO1] [L2] **10**
- Q.4 Analyze the "Development of Picturesque" in the landscape and building of 17th-18th century. [CO2] [L4] **10**

PART-B

- Q.5 Outline the characteristics of renaissance and post renaissance in architecture. [CO3] [L4] **10**
- Q.6 Analyze the development of arches and vault by taking examples from Romanesque period. [CO5] [L4] **10**
- Q.7 Discuss the architectural styles of St. Peter's Basilica. [CO6] [L2] **10**

End Semester Examination, May 2023

Bachelor of Architecture – Fourth Semester

BUILDING SERVICES-I (WATER SUPPLY AND SANITATION (AR-308A)

Time: 3 hrs.

Max Marks: **40**

No. of pages: **1**

Note: Attempt **FIVE** questions in all; **Q.1 is compulsory**. Attempt any **TWO** questions from **PART-A** and **TWO** questions from **PART-B**. Marks are indicated against each question.

Q.1 Answer the following in brief:

- a) Explain in brief the different sources of water. [CO-3][L-1]
- b) What do you understand by building services? [CO-1][L-2]
- c) Enunciate the Importance of rain water harvesting. [CO-6][L-1]
- d) Summarize the different types of pipe materials and fixtures. [CO-2][L-2] **2×4**

PART-A

- Q.2 Discuss the Historical overview of development of water systems. [CO-1][L-2] **8**
- Q.3 With proper diagram explain in details of the water treatment plant. [CO-2] [L-3] **8**
- Q.4 Write a well detailed note on "Water supply in multi storied buildings with reference to domestic demands." [CO-3] [L-2] **8**

PART-B

- Q.5 Detail a septic tanks and explain each component with proper diagrams. [CO-4] [L-3] **8**
- Q.6 With proper diagram, explain in details the conveyance of network for sewerage disposal system. [CO-5] [L-3] **8**
- Q.7 Write down the application of design for water sewerage systems highlighting its Advantages and disadvantages. [CO-6] [L-2] **8**

End Semester Examination, May 2023
Bachelor of Architecture — Third Semester
BUILDING SERVICES-I (WATER SUPPLY AND SANITATION)
(AR-308A)

Time: 3 hrs.

Max Marks: **40**

No. of pages: **1**

Note: Attempt **FIVE** questions in all; **Q.1** is **compulsory**. Attempt any **TWO** questions from **PART-A** and **TWO** questions from **PART-B**. Marks are indicated against each question.

Q.1 Answer the following questions:

- a) Explain the term: "Building Services". Highlight its classifications. [CO1] [L2]
- b) Explain the various sources of water. [CO2] [L2]
- c) List the various types of pipe systems used in domestic sewerage system. [CO5] [L1]
- d) Explain the term: "desalination". [CO3] [L2] **2×4**

PART-A

Q.2 Write a detailed note on: The historical development of water systems. [CO1] [L3] **8**

Q.3 The following is the population data of a city, available from past census records. Determine the population of the city in 2011 by: Arithmetic increase method and Geometric increase method:

Year	1931	1941	1951	1961	1971	1981	1991
Population	12000	16500	26800	41500	57500	68000	74100

[CO2] [L4] **8**

Q.4 Explain the different methods for distribution of domestic water supply. [CO3] [L2] **8**

PART-B

Q.5 Write detailed notes on "cast iron pipes" and "galvanised iron pipes". [CO3] [L2] **8**

Q.6 Enunciate the process of "rainwater harvesting". [CO5] [L2] **8**

Q.7 Illustrate the various sewerage network systems in detail. [CO6] [L3] **8**

End Semester Examination, May 2023
Bachelor of Architecture — Third Semester
PRINCIPLES OF HUMAN SETTLEMENTS-I (AR-310)

Time: 3 hrs.

Max Marks: **40**

No. of pages: **1**

Note: Attempt **FIVE** questions in all; **Q.1** is **compulsory**. Attempt any **TWO** questions from **PART-A** and any **TWO** questions from **PART-B**. Marks are indicated against each question.

- Q.1 Discuss the origin of human settlements with reference to early river valley civilizations of Indus valley, Egypt, China and Mesopotamia. **8**

PART-A

- Q.2 What is the influence of resources in defense, trade and politics in the development of settlement planning for Greek and Roman civilizations? How did industrial revolution influence the development? [CO2] [L1] **8**
- Q.3 Discuss the factors leading to the factors for the development of medieval Indian cities. Give examples of any two Indian cities during Colonial Rule. [CO3] [L2] **8**
- Q.4 Write down the planning principles of Le Corbusier's Chandigarh. Draw rough sketch to show road network and segregation pattern of industrial, institutional and residential areas. [CO6] [L3] **8**

PART-B

- Q.5 What were the contributions and theories for city planning of any one: Patrick Geddes or Ebenezer Howard? [CO6] [L4] **8**
- Q.6 What are the modern town planning principles? Explain giving examples of any city development in Europe or America. [CO6] [L5] **8**
- Q.7 Throw a light on the development of human settlements in the changing world. Give any one example of city development of a modern /post modern city. [CO5] [L4] **8**

End Semester Examination, May 2023
Bachelor of Architecture — Fourth Semester
HISTORY OF ARCHITECTURE-II (AR-404A)

Time: 3 hrs.

Max Marks: **40**

No. of pages: **1**

Note: Attempt **FIVE** questions in all; **Q.1** is **compulsory**. Attempt any **TWO** questions from **PART-A** and **TWO** questions from **PART-B**. Marks are indicated against each question.

Q.1 Explain (**any four**) of the following:

- a) Pendentive.
- b) Pilaster.
- c) Arcade.
- d) Nave.
- e) Pediment.
- f) Gargoyles.

[CO1] [L1] **2×4**

PART-A

Q.2 Draft the plan of the earliest basilicas in early christian architecture. Explain the terminology and architectural features of churches of early Christian architecture.

[CO2] [L2] **8**

Q.3 Mention the architectural features of the Romansque and Gothic architecture. Support your answer with sketches.

[CO3] [L3] **8**

Q.4 Describe in detail the about the architecture that flourished in the new capital of Roman Empire made by the emperor Constantine. Also explain the architectural features of Hagia Sophia and mention how it is different from the churches of early Christian architecture.

[CO4] [L4] **8**

PART-B

Q.5 Mention the contributions given by the architect Filippo Brunelleschi during the early Renaissance phase. Explain the Renaissance architecture and its architectural features.

[CO5] [L5] **8**

Q.6 Explain the Differences between the Architectural works of the high and late Renaissance architecture. Support your answer with the examples of Dunato Bramante and Andrea Palladio.

[CO5] [L5] **8**

Q.7 Mention the contributions of the following architects to the modern and post modern architecture. Support your answer with examples of their famous works.

- a) F. L. Wright
- b) Walter Gropius.

[CO6] [L6] **4×2**

End Semester Examination, May 2023

Bachelor of Architecture – Fourth Semester

HISTORY OF ARCHITECTURE-II (AR-404A)

Time: 3 hrs.

Max Marks: **40**

No. of pages: 1

Note: Attempt **FIVE** questions in all; **Q.1 is compulsory**. Attempt any **TWO** questions from **PART-A** and **TWO** questions from **PART-B**. Each question carries equal marks.

Q.1 Write short notes on **(any four)** of the following:

- a) Pendentive.
- b) Pilaster.
- c) Arcade.
- d) Nave.
- e) Pediment.
- f) Gargoyles.

[CO-1] [L-1] **2×4**

PART A

Q.2 With the help of detailed diagrammatic representation of the earliest Basilica, explain the terminology and architectural features of churches of early Christian architecture. [CO-2] [L-2] **8**

Q.3 Differentiate between the Architectural features of the Romansque and Gothic architecture. Support your answer with sketches. [CO-3] [L-3] **8**

Q.4 Discuss about the architecture that flourished in the new capital of Roman Empire made by the emperor Constantine. Write in Detail about the architectural features of Hagia Sophia and mention how it is different from the churches of early Christian Architecture [CO-4] [L-4] **8**

PART B

Q.5 Explain the Renaissance Architecture and its architectural features. Mention the contributions given by the Architect Filippo Brunelleschi during the early Renaissance Phase. [CO-5] [L-5] **8**

Q.6 Differentiate between the Architectural works of the high and late Renaissance architecture. Support your answer with the examples of Donato Bramante and Andrea Palladio. [CO-5] [L-5] **8**

Q.7 Describe the Modern and Post Modern Architecture. Mention the contributions of F.L.Wright and Walter Gropius to the world of architecture. [CO-6] [L-6] **8**

End Semester Examination, May 2023

Bachelor of Architecture – Fourth Semester STRUCTURAL DESIGN – IV (AR-405B)

Time: 3 hrs.

Max Marks: **40**

No. of pages: **1**

Note: Attempt **FIVE** questions in all; **Q.1 is compulsory**. Attempt any **TWO** questions from **PART-A** and **TWO** questions from **PART-B**. Marks are indicated against each question.

Use IS 456:2000. Assume any data if not given.

- Q.1 a) What is characteristic strength?
b) Write factor of safety and partial factor of safety for concrete and steel?
c) Why we do not use over-reinforced sections?
d) Explain the importance of "Bar Bending Schedule" for design and analysis of structural elements. [CO-2] [L-3] **2×4**

PART-A

- Q.2 Correlate the design philosophy of "Limit State Method" with the guidelines laid in IS 456:2000. [CO-1] [L-3] **8**
- Q.3 Design a rectangular beam 230 mm X 600 mm over an effective span of 5 m. The superimposed load on the beam is 50 kN/m. Effective cover to reinforcement is taken as 50 mm. Use M20 concrete and Fe 415 steel. [CO-2] [L-2] **8**
- Q.4 Evaluate the MOR from sides of extreme fibres in a rectangular beam of size 500 mm x 660 mm is used for simply supported, effective span of 7.5 m. Use M 30 concrete and Fe 415 steel. The beam is provided with 5 nos. of 28 mm dia bars and effective cover is 60 mm. [CO-3] [L-4] **8**

PART-B

- Q.5 Design a one-way slab with a clear span of 3.5 m, simply supported on 200 mm thick concrete masonry walls to support a live load of 5kN/m². Adopt M20 grade of concrete and Fe 415 HYSD bars. [CO-4] [L-4] **8**
- Q.6 Correlate the importance of "Waist Slab" with staircase. Summarize the steps involved in the designing of waist slabs with a neat sketch. [CO-6] [L-3] **8**
- Q.7 A straight staircase is made of structurally independent tread slabs, cantilevered from a reinforced concrete wall. Given that the riser is 150 mm tread is 300 mm and width of flight is 1.5 m, design a typical tread slab. Apply the live load 5 kN/m². Use M20 concrete and Fe250 steel. Assume mild exposure conditions. [CO-6] [L-5] **8**

End Semester Examination, May 2023

Bachelor of Architecture – Fourth Semester STRUCTURAL DESIGN – IV (AR – 405B)

Time: 3 hrs.

Max Marks: **40**

No. of pages: **1**

Note: Attempt **FIVE** questions in all; **Q.1 is compulsory**. Attempt any **TWO** questions from **PART-A** and **TWO** questions from **PART-B**. Marks are indicated against each question.

Q.1 Answer the following questions:

- a) Compare the principles of "Working Stress Method" and "Limit State Method".
[CO-1] [L-2]
- b) Explain the importance of "Bar Bending Schedule" for design and analysis of structural elements.
[CO-2] [L-3]
- c) With the help of neat sketch, explain the components of a typical "T – Beam".
[CO-3] [L-2]
- d) Illustrate the load transfer mechanism in Two – Way Slab. [CO-4] [L-2] **2×4**

PART-A

Q.2 Correlate the design philosophy of "Limit State Method" with the guidelines laid in IS 456: 2000. [CO-1] [L-3] **8**

Q.3 Elaborate the significance of "Development Length" in context with design of beam. [CO-2] [L-2] **8**

Q.4 Evaluate the MOR from sides of extreme fibres in a rectangular beam of size 500 mm x 660 mm is used for simply supported, effective span of 7.5 m. Use M 30 concrete and Fe 415 steel. The beam is provided with 5 nos. of 28 mm dia bars and Effective cover is 60 mm. [CO-3] [L-4] **8**

PART-B

Q.5 As per the guidelines of IS 456: 2000 state some of the important points need to be consider while designing for a column. [CO-5] [L-3] **8**

Q.6 Plan a mechanism to design a one – way slab. [CO-4] [L-5] **8**

Q.7 Correlate the importance of "Waist Slab" with staircase. Summarize the steps involved in the designing of waist slabs with a neat sketch. [CO-6] [L-3] **8**

End Semester Examination, May 2023
Bachelor of Architecture — Fourth Semester
BUILDING SERVICES-II (ELECTRICAL SERVICES AND ILLUMINATION)
(AR-406A)

Time: 3 hrs.

Max Marks: **40**

No. of pages: **1**

Note: Attempt **FIVE** questions in all; **Q.1** is **compulsory**. Attempt any **TWO** questions from **PART-A** and **TWO** questions from **PART-B**. Marks are indicated against each question.

Q.1 Answer the following in brief:

- a) What is meant by sanitation?
- b) State Ohm's law.
- c) What is meant by reflection of light?
- d) What is meant by absorption of light?

[CO1] [L1] **2×4**

PART-A

Q.2 Explain the different types of sanitation systems used in buildings. [CO1] [L2] **8**

Q.3 How is protection given against short circuit, lightning and overloading in a building? [CO2] [L1] **8**

Q.4 Classify different sources of lighting. [CO3] [L3] **8**

PART-B

Q.5 Compare the different sources of lighting available for interior and exterior lighting. [CO4] [L5] **8**

Q.6 Compare the different causes of fire in a building. [CO5] [L4] **8**

Q.7 Draw layout of a commercial office of dimensions 30 × 30 feet length and breadth. Required illumination is 50FC and sources available range from 200 lumens to 3500 lumens. [CO6] [L6] **8**

End Semester Examination, May 2023
Bachelor of Architecture — Fourth Semester
VERNACULAR ARCHITECTURE (AR-408A)

Time: 3 hrs.

Max Marks: **40**

No. of pages: **1**

Note: Attempt **FIVE** questions in all; **Q.1** is **compulsory**. Attempt any **TWO** questions from **PART-A** and **TWO** questions from **PART-B**. Marks are indicated against each question.

- Q.1 Explain vernacular architecture. What architectural elements play a role in design of vernacular buildings? [CO1] [L1] **8**

PART-A

- Q.2 Explain cold, sunny and composite biodiversity influence on vernacular design. [CO1] [L1] **8**

- Q.3 Explain “kucha”, “semi-pakka” and bamboo construction, their properties in terms of vernacular architecture. [CO2] [L2] **8**

- Q.4 Explain vernacular architecture of North East India, along with examples and drawings of any three tribes of that region. [CO3] [L1] **8**

PART-B

- Q.5 Explain briefly influence of climate in vernacular architecture of Southern India. [CO5] [L1] **8**

- Q.6 Write about vernacular architecture and disaster management in relation to Northern region. [CO5] [L1] **8**

- Q.7 Explain Haveli architecture, definition and influence. [CO6] [L3] **8**

End Semester Examination, May 2023

Bachelor of Architecture – Fourth Semester **VERNACULAR ARCHITECTURE (AR-408A)**

Time: 3 hrs.

Max Marks: **40**

No. of pages: **1**

Note: Attempt **FIVE** questions in all; **Q.1 is compulsory**. Attempt any **TWO** questions from **PART-A** and **TWO** questions from **PART-B**. Marks are indicated against each question.

- Q.1 Define the term “vernacular architecture”. Explain in detail how climate of a region impact the vernacular architecture. [CO-1] [L-1] **8**

PART-A

- Q.2 Discuss in detail about **any two** of the following vernacular construction techniques and explain:
a) Dhajji construction technique.
b) Kath-Kuni construction technique.
c) Koti Banal technique.
d) Bhunga construction technique. [CO-2] [L-2] **4×2**

- Q.3 Enlist three vernacular materials and state the role of construction technology in vernacular architecture. [CO-3] [L-3] **8**

- Q.4 Haveli architecture is a unique vernacular architecture form that flourished in various parts of Northern India. Justify the Statement. [CO-4] [L-4] **8**

PART-B

- Q.5 Explain the vernacular strategies for the disaster resistant structures in various parts of disaster prone areas in India. [CO-5] [L-5] **8**

- Q.6 Explain in detail, the influence of climate on vernacular architecture of Northern India. Support your answer with various examples. [CO-5] [L-5] **8**

- Q.7 Differentiate between any two vernacular construction techniques used in the southern regions of India. Support your answer with sketches. [CO-6] [L-6] **8**

End Semester Examination, May 2023
Bachelor of Architecture — Fourth Semester
PRINCIPLE OF HUMAN SETTLEMENTS (AR-409)

Time: 3 hrs.

Max Marks: **40**

No. of pages: **1**

Note: Attempt **FIVE** questions in all; **Q.1** is **compulsory**. Attempt any **TWO** questions from **PART-A** and any **TWO** questions from **PART-B**. Marks are indicated against each question.

Q.1 Explain the following (**any two**):

- a) Rehabilitation.
- b) Conservation.
- c) Rural settlements.
- d) SEZ.

4×2

PART-A

Q.2 Define elements and principles of Ekistics. [CO1] [L1] **8**

Q.3 Classify the factors influencing the growth and decay of human settlements. [CO2] [L2] **8**

Q.4 Describe 'Regional Plan'. Write about policies for Regional Development in India. [CO3] [L3] **8**

PART-B

Q.5 Differentiate between an urban planning and an urban renewal. [CO4] [L4] **8**

Q.6 Write about sustainable planning concepts in detail. [CO5] [L5] **8**

Q.7 Explain Transit Oriented Development (TOD) with an example. [CO6] [L6] **8**

End Semester Examination, May 2023
Bachelor of Architecture – Forth Semester
PRINCIPLE OF HUMAN SETTLEMENTS (AR-409)

Time: 3 hrs.

Max Marks: **40**

No. of pages: **1**

Note: Attempt **FIVE** questions in all; **Q.1 is compulsory**. Attempt any **TWO** questions from **PART-A** and **TWO** questions from **PART-B**. Marks are indicated against each question.

Q.1 Explain (**any two**) of the following terms:

- a) Master plan.
- b) Urban renewal.
- c) TOD.
- d) Regional development.

4×2

PART-A

Q.2 Elaborate the urban planning in India and the scope, content and limitations planning
[CO-1] [L-1] **8**

Q.3 Explain rural development and explain any three rural development programs of India.
[CO-2] [L-2] **8**

Q.4 Explain the relation between human beings and settlements. Nature, shells and networks- their functions and linkages.
[CO-3] [L-3] **8**

PART-B

Q.5 Explain the hierarchical system of settlements, their sizes and functions. [CO4][L-3] **8**

Q.6 Explain the impact of globalization on the cities of India. [CO-5] [L-5] **8**

Q.7 Define Urban planning and explain any five components of Urban planning.
[CO-6] [L-6] **8**

End Semester Examination, May 2023

Bachelor of Architecture – Fifth Semester

STRUCTURAL DESIGN-V (AR-505)

Time: 3 hrs.

Max Marks: 60

No. of pages: 1

Note: Attempt **FIVE** questions in all; **Q.1 is compulsory**. Attempt any **TWO** questions from **PART-A** and **TWO** questions from **PART-B**. All questions carry equal Marks.

Q.1 Answer the following in brief:

- Draw a free hand sketch of a counterfort Retaining Wall (RW) and mark its component.
- How do you calculate factor of safety of a RW against sliding?
- Explain $1/6^{\text{th}}$ rule in case of a RW.
- Why section of a counterfort RW is thinner than that of a cantilever RW of same height.
- Define welding.
- What is the difference between butt joint and lap joint? Explain with sketch.
- Name the types of Tension members.
- Mention the end condition and its corresponding effective length for two cases in case of a compression member.

1½x8

PART-A

Q.2 Write down types of retaining walls. Explain all of them with neat sketches. 12

Q.3 Design a cantilever retaining wall to retain horizontal earthen embankment of height 4m above the ground level. The earthen backfill is having a density of 18 KN/m^3 and angle of internal friction as 30° . The safe bearing capacity of the soil is 80 KN/m^3 . The coefficient of friction between soil and concrete is assumed as 0.45. Design stem of this retaining wall too. Use M20 concrete and Fe415 steel. 12

Q.4 a) What is shear wall? Write type of shear wall and explain them. 6
b) Design a shear wall having height and length of 3m and 4m respectively. Shear wall have thickness of 100mm and carrying load of 600 kN/m . Use M20 concrete and Fe415 steel. Assume $d^1/D = 0.1$. 6

PART-B

Q.5 Design a Lap joint between two plates as show in the figure, so as to transmit a factored load of 60kN using M20 bolts of grade 4.6 and grate 410 plates. 12

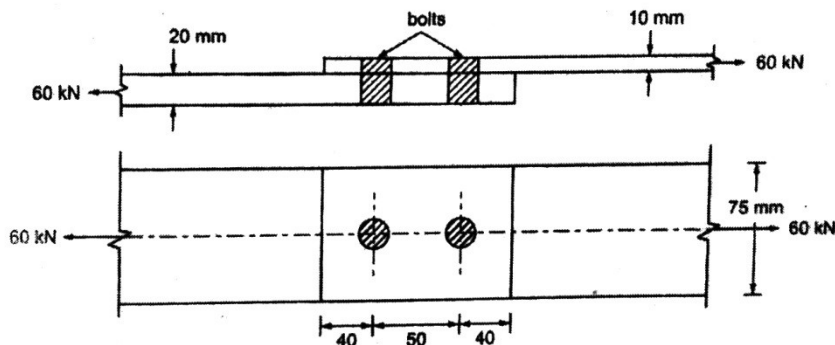

Q.6 Determine the design axial load on the column section ISMB @710.3 N/m, height of column is 4 m and pin-ended. Assume that $f_y = 250 \text{ N/mm}^2$, and $f_u = 410 \text{ N/mm}^2$, $E = 2 \times 10^5 \text{ N/mm}^2$. 12

Q.7 Determine the design bending strength of a beam ISMB @434 N/m. Assume that the factored shear is less than the design shear strength. Use Fe 410 grade steel. 12 30

End Semester Examination, May 2023
Bachelor of Architecture — Fifth Semester
STRUCTURAL DESIGN-V (AR-505B)

Time: 3 hrs.

Max Marks: **40**

No. of pages: **1**

Note: Attempt **FIVE** questions in all; **Q.1** is **compulsory**. Attempt any **TWO** questions from **PART-A** and **TWO** questions from **PART-B**. Marks are indicated against each question.

- Q.1 Answer the following in brief:
- a) With the help of a neat sketch, elaborate "trapezoidal footing". [CO1] [L2]
 - b) Explain the significance of well foundation. [CO2] [L2]
 - c) Compare the concept of "prestressing" and "post stressing"? [CO3] [L2]
 - d) With the help of neat sketch, illustrate the load transfer mechanisms in different types of slab. [CO4] [L1]
 - e) Draw ILD for determination of horizontal thrust in case of a two - hinged arch when the load is placed beyond the support over the arch. [CO5] [L1] **2×5**

PART-A

- Q.2 Summarize the concept and functions of "shallow" and "deep" foundations. [CO2] [L3] **8**
- Q.3 A combined footing is to be provided for two columns carrying loads of 1500 kN and 2800 kN respectively. The centre – to – centre distance between these columns is 9m. Determine the size of footing if the width of the footing is 3.0 m and the safe bearing capacity of the soil is 120 kN/m². [CO1] [L2] **8**
- Q.4 With the help of a neat sketch, elaborate the stresses developed in a prestressed concrete member when the reinforcement is provided as a straight cable at an eccentricity 'e' below the NA. [CO3] [L6] **8**

PART-B

- Q.5 Plan a mechanism to design a two - way slab as per the codal provisions of IS 456: 2000. [CO4] [L3] **7**
- Q.6 With the help of neat sketches, write an explanatory note on "temperature effects in three - hinged arch. [CO5] [L5] **7**
- Q.7 Summarize the different "wall systems" as per the guidelines of IS 16700: 2017. [CO6] [L5] **7**

End Semester Examination, May 2023
Bachelor of Architecture — Fifth Semester
BUILDING SERVICES-III (LIGHTING AND ACOUSTICS) (AR-507)

Time: 3 hrs.

Max Marks: **60**

No. of pages: **1**

Note: Attempt **FIVE** questions in all; **Q.1** is **compulsory**. Attempt any **TWO** questions from **PART-A** and **TWO** questions from **PART-B**. Marks are indicated against each question.

- Q.1 Answer the following in brief:
- a) List some artificial sources of lighting. [CO3] [L2]
 - b) Explain "Lux" with regards to artificial lightings. [CO3] [L2]
 - c) What are the factors that determines the day light factors? [CO1] [L2]
 - d) List some sound amplification systems. [CO4] [L3]
 - e) Explain "coefficient of utilization". [CO2] [L1]
 - f) Explain "wave theory with regards to concepts of acoustics". [CO3] [L1]
 - g) List some items used for noise control. [CO2] [L2]
 - h) Explain "reverberation time". [CO4] [L1] **1½×8**

PART-A

- Q.2 Explain the lighting levels required for various areas highlighting its importance in architectural design. [CO1] [L2] **12**
- Q.3 Elaborate the different types of lamps and luminaries. [CO2] [L2] **12**
- Q.4 Illustrate a well detailed note on the physical parameters of day lighting. [CO3] [L4] **12**

PART-B

- Q.5 Write a detailed note on the methods for controlling mechanical noise and vibrations. [CO6] [L2] **12**
- Q.6 Design a theoretical framework for acoustical design of auditorium. [CO5] [L5] **12**
- Q.7 Enunciate the characteristics of sound absorbing materials. [CO4] [L2] **12**

End Semester Examination, May 2023
Bachelor of Architecture – Sixth Semester
ESTIMATING COSTING AND SPECIFICATIONS (AR-603B)

Time: 3 hrs.

Max Marks: **40**

No. of pages: **1**

Note: Attempt **FIVE** questions in all; **Q.1 is compulsory**. Attempt any **TWO** questions from **PART-A** and **TWO** questions from **PART-B**. Each question carries equal marks.

Q.1 Explain the following (**any two**):

- a) Quantity surveying.
- b) Rate analysis.
- c) Standard schedule of rates.

4×2

PART-A

Q.2 Explain the purpose of specifications and the classifications in detail. [CO-1] [L-1] **8**

Q.3 List out the data required for preparation of an estimate? Write the tabular form for the detailed estimate. [CO-2] [L-2] **8**

Q.4 Define quantity surveying and its importance. [CO-3] [L-1] **8**

PART-B

Q.5 Define estimating and costing and state the need of estimating and costing. [CO-1] [L-1] **8**

Q.6 What do you understand by rate analysis and the factor affecting the rate analysis. [CO-5] [L-5] **8**

Q.7 Estimate the quantities of the following items of a two roomed building for the given plan , elevation and sections below:
a) Earthwork in excavation in foundation.
b) 1st class brickwork in cement mortar in foundation.
c) First class brick work in superstructure in lime mortar.

[CO- 2] [L- 6] **8**

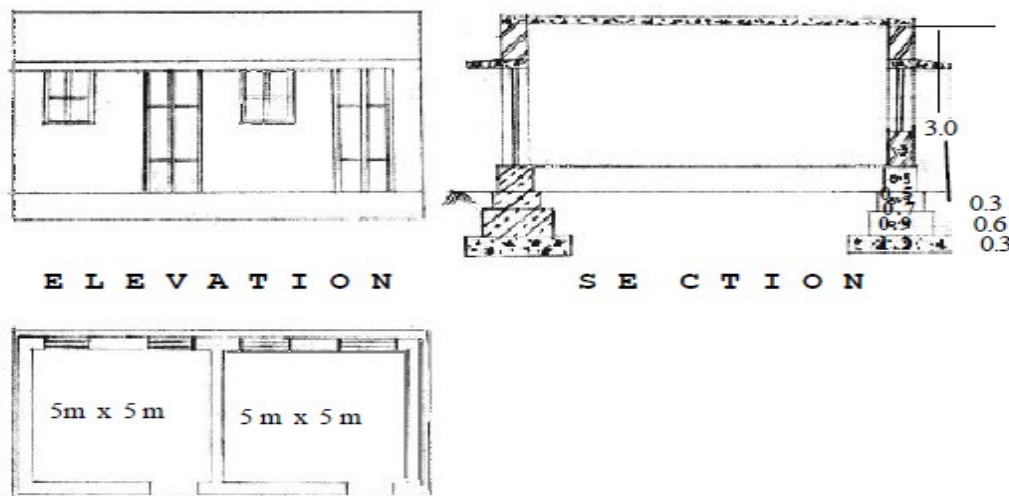

D - Door 1.00 m x 2.00 m
W - Window 1.2 m x 1.2 m

End Semester Examination, May 2023

Bachelor of Architecture – Sixth Semester

HISTORY OF ARCHITECTURE-IV (AR-604B)

Time: 3 hrs.

Max. Marks: **40**

No. of pages: 1

Note: Attempt **FIVE** questions in all; **Q.1 is compulsory**. Attempt any **TWO** questions from **PART-A** and **TWO** questions from **PART-B**. Marks are indicated against each question.

- Q.1 Explain the various factors that contributed to the formation of different styles of architecture in India. **8**

PART-A

- Q.2 Explain the regional adaptation of Islamic architecture in India. [CO-1] [L-1] **8**

- Q.3 Describe the special features of the prominent sites Khirki Masjid and Qutub complex. [CO-2] [L-2] **8**

- Q.4 Explain the architectural features of Islamic architecture in India with suitable examples. [CO-3] [L-3] **8**

PART-B

- Q.5 What are Charles Correa and B.V. Doshi's various works in India? [CO-4] [L-4] **8**

- Q.6 Summarize the colonial style of architecture in India with the help of suitable examples. [CO-5] [L-5] **8**

- Q.7 How did the colonization of India by the Portuguese, French, Dutch, and British affect the architecture of India? [CO-6] [L-6] **8**

End Semester Examination, May 2023

Bachelor of Architecture – Sixth Semester

STRUCTURAL DESIGN – VI (AR-605B)

Time: 3 hrs.

Max Marks: **40**

No. of pages: **1**

Note: Attempt **FIVE** questions in all; **Q.1 is compulsory**. Attempt any **TWO** questions from **PART-A** and **TWO** questions from **PART-B**. Marks are indicated against each question.

Q.1 Answer the following in brief:

- a) With the help of a neat sketch, explain the significance of "ISMB 450" and "ISRO 500". [CO-1] [L-2]
- b) Compare "Pitch" and "Gauge Distance". [CO-2] [L-2]
- c) What do you understand by the term "Slot Welding"? [CO-3] [L-2]
- d) State the assumptions made in the design of axially loaded compression members. [CO-4] [L-1] **2×4**

PART-A

- Q.2 Write a short note on types of structural steel. [CO-1] [L-3] **8**
- Q.3 List the assumptions made in the bolted connection. [CO-2] [L-2] **8**
- Q.4 A tie member of a roof truss consists of ISA 100×75×8 of Fe 410 grade, is welded to a 10 mm gusset plate. Design the welded connection to transmit a tensile load, T. Assume connection is made in the workshop. [CO-3] [L-6] **8**

PART-B

- Q.5 As per the guidelines of IS 800: 2007, state the design specifications for lacing system as a compression member. [CO-4] [L-3] **8**
- Q.6 With the help of neat sketches, write an explanatory note on "maximum deflections of various beam elements. [CO-5] [L-5] **8**
- Q.7 Plan a mechanism for design of Tension Members. [CO-6] [L-5] **8**

End Semester Examination, May 2023
Bachelor of Architecture – Sixth Semester
GREEN AND INTELLIGENT BUILDINGS (AR-607A)

Time: 3 hrs.

Max Marks: **40**

No. of pages: 1

Note: Attempt **FIVE** questions in all; **Q.1 is compulsory**. Attempt any **TWO** questions from **PART-A** and **TWO** questions from **PART-B**. Marks are indicated against each question.

- Q.1 Explain the following:
- a) Green rating.
 - b) Solarium.
 - c) Dual plumbing system.
 - d) Stack effect.

2×4

PART-A

- Q.2 Explain any five concepts covered by green smart building with the help of sketches and charts. [CO-1][L-1] **8**
- Q.3 Explain the rating system of India and name any 5 worldwide rating systems with their selection criteria. [CO- 2][L- 2] **8**
- Q.4 Explain in detail key parameters considered in a green building rating systems worldwide." [CO-3][L-3] **8**

PART-B

- Q.5 Design the relation between BMS and Intelligent building and its evolving role as a digital hub. [CO-4][L-4] **8**
- Q.6 What are the key issues to be taken care while designing an intelligent building? [CO-5][L- 5] **8**
- Q.7 Explain in detail the layout of green building and areas of integrated design. [CO-6][L- 6] **8**

End Semester Examination, May 2023
Bachelor of Architecture – Sixth Semester
**BUILDING SERVICES-IV (MECHANICAL SYSTEMS SERVICES AND
HVAC) (AR-608B)**

Time: 3 hrs.

Max Marks: **40**

No. of pages: **1**

Note: Attempt **FIVE** questions in all; **Q.1 is compulsory**. Attempt any **TWO** questions from **PART-A** and **TWO** questions from **PART-B**. Marks are indicated against each question.

- Q.1 Draw a false ceiling drawing with floor level and marking different HVAC, electrical accessories showing the dimension of clearance spaces. [CO-1][L-1] **8**

PART-A

- Q.2 What specific factor is taken into account in the HVAC system of a library? [CO-1][L-1] **8**
- Q.3 a) Describe vapour compression refrigeration system with diagram. [CO-2][L-3] **4**
b) Explain with diagram natural and artificial ventilation. [CO-2][L-3] **4**
- Q.4 Draw hand sketch of vertical shaft showing accessories of HVAC [CO-3][L-3] **8**

PART-B

- Q.5 What is difference between fine and HEPA filter? [CO-4][L-4] **8**
- Q.6 What is function of boiler in central HVAC system? [CO-5][L-5] **8**
- Q.7 What is difference between Fan coil unit and Air handling unit? Why fan coil unit application is preferred in hotel cabins and class rooms? [CO-6][L-6] **8**

End Semester Examination, May 2023
Bachelor of Architecture — Seventh Semester
TRAFFIC AND TRANSPORTATION (AR-704A)

Time: 3 hrs.

Max Marks: **40**

No. of pages: **1**

Note: Attempt **FIVE** questions in all; **Q.1** is **compulsory**. Attempt any **TWO** questions from **PART-A** and **TWO** questions from **PART-B**. Marks are indicated against each question.

- Q.1 Write short notes on the following:
- a) Traffic system management measures.
 - b) Alignment of road and its types.
 - c) National transit oriented development (TOD) policy.
 - d) Intercity and intra city roads.

2×4

PART-A

- Q.2 Classify various “hierarchies of roads” and draw cross-sectional elements for urban roads. [CO1] [L1] **8**
- Q.3 Explain the fundamental design considerations for the design of roads. [CO2] [L2] **8**
- Q.4 Illustrate the types of traffic surveys with a focus on their objectives and the respective methodologies involved. [CO3] [L3] **8**

PART-B

- Q.5 Describe the characteristics of traffic flow and justify the relationship between those parameters. [CO4] [L4] **8**
- Q.6 Explain the various kinds of surveys in transportation. [CO5] [L5] **8**
- Q.7 Analyze the National urban transportation policy, 2016 Also, state the various initiatives taken by the government regarding traffic management and planning. [CO6] [L4] **8**

End Semester Examination, May 2023

Bachelor of Architecture – Tenth Semester

PROJECT MANAGEMENT (AR-1002A)

Time: 3 hrs.

Max Marks: **40**

No. of pages: 1

Note: Attempt **FIVE** questions in all; **Q.1 is compulsory**. Attempt any **TWO** questions from **PART-A** and **TWO** questions from **PART-B**. Marks are indicated against each question.

Q.1 What is the role of a project manager in a construction project? [CO-1][L-1] **8**

PART-A

Q.2 What are the phases in project management? What are the key factors for a successful project control? [CO-1][L-1] **8**

Q.3 What is the direct, indirect and project cost model in a project management? [CO-2][L-2] **8**

Q.4 Explain AON and AOA network logic with diagrams. [CO-3][L-3] **8**

PART-B

Q.5 What are time constrained and resource constrained scheduling, also explain what are calendar and ordinal dates in scheduling? [CO-4][L-4] **8**

Q.6 What is cost optimization? Write the steps to be followed for achieving cost optimization. [CO-5][L-5] **8**

Q.7 What is PERT network? Explain theory of probability. [CO-6][L-6] **8**

End Semester Examination, May 2023

Bachelor of Architecture – Tenth Semester

PROFESSIONAL PRACTICE (AR-1003A)

Time: 3 hrs.

Max Marks: **40**

No. of pages: 1

Note: Attempt **FIVE** questions in all; **Q.1 is compulsory**. Attempt any **TWO** questions from **PART-A** and **TWO** questions from **PART-B**. Marks are indicated against each question.

Q.1 Illustrate the role of COA in architecture profession. **8**

PART-A

Q.2 List the professional duties of architects. Why are professional ethics important for an architect? [CO-1][L-2] **8**

Q.3 Elaborate Tender and explain list of information given in Tender. What are the various types of Tenders? [CO-2][L-3] **8**

Q.4 Illustrate the scope of architectural copyright protection. [CO-3][L4] **8**

PART-B

Q.5 Illustrate the arbitration and its importance. [CO-4][L-1] **8**

Q.6 What are the functions and powers of COA? Define 'Architects Act of 1972'. [CO-5][L-2] **8**

Q.7 What are the objectives of contracts and list the types of contracts? [CO-6][L-5] **8**

End Semester Examination, May 2023

Bachelor of Architecture — First Semester

COMMUNICATION-I (BDES-107) / (BID-DS-107)

Time: 1½ hrs.

Max Marks: **50**

No. of pages: 4

Note: All questions are **compulsory**. Each question has **FOUR** options with **ONE** correct answer. Select the correct answer. All questions are of **ONE** mark each. There is no **NEGATIVE** marking. Mention the correct option for each question in the blank answer key given herein below. Calculator is not permitted. Use only black or blue pen.

1)	2)	3)	4)	5)	6)	7)	8)	9)	10)
11)	12)	13)	14)	15)	16)	17)	18)	19)	20)
21)	22)	23)	24)	25)	26)	27)	28)	29)	30)
31)	32)	33)	34)	35)	36)	37)	38)	39)	40)
41)	42)	43)	44)	45)	46)	47)	48)	49)	50)

- Q.1 Each of the winners _____ a scholarship and a trophy.
 a) Received b) Receiving
 c) Receives d) Receive [L3][CO2]
- Q.2 Everyone in class _____ to study.
 a) Need b) Needing
 c) Needs d) Needed [L1][CO1]
- Q.3 Where _____ your grandmother and grandfather live?
 a) Does b) Do
 c) Did d) None of these [L1][CO1]
- Q.4 A lot of people always say that they don't have time to do what they want or need to do when in fact.
 a) They know how to organise their activities.
 b) They don't know how to calculate their activities.
 c) They don't know how to organise their activities
 d) They don't know how to reduce their activities. [L3][CO2]
- Q.5 To spend your time productively, you need to have set some _____.
 a) Short Term Goals b) Long Term Goals
 c) SMART Goals d) Goals [L1][CO1]
- Q.6 Which word means to delay or put off doing something by wasting your time on less important tasks?
 a) Postpone b) Procrastinate
 c) Abandon d) Cancel [L3][CO2]
- Q.7 You and your family need to be at an important appointment by 7:00 p.m. It's a 30-minute drive. When do you leave your house?
 a) At 6:45, unfortunately. We'll call to say we're running late
 b) At 6:30, obviously.
 c) Early enough to allow time to load up the kids and all our stuff, so that we're in the car and on the road by 6:30.
 d) Depends on when we are ready to leave. [L3][CO1]
- Q.8 What's the one thing that doesn't belong on a to-do list?
 a) A detailed list of all tasks for the day. b) The amount of time each task will take.
 c) The movie you want to watch. d) That yoga class you'd like to take. [L3][CO1]

- Q.9 What's your relationship with social media?
 a) We're tight. I check Twitter and Instagram first thing in the morning and last thing before bed.
 b) It's reasonable. I use it to keep up with people and events, but it doesn't dominate my life.
 c) It's over. I quit using it because it's such a time suck.
 d) I was only going to check Facebook for five minutes, I swear! What happened to the last two hours? [L3][CO1]
- Q.10 How many minutes does the average Indian spend commuting to work/college each day?
 a) 29. b) 25.
 c) 38. d) 20. [L3][CO1]
- Q.11 You've got some unexpected downtime while waiting to pick up family or friends. What do you do?
 a) Text a friend. b) Check my social accounts.
 c) Play some games. d) Any of the above. [L3][CO1]
- Q.12 What part of SMART is missing from this goal? I will improve my grade in science.
 a) Not Time Bound b) Not Specific enough
 c) Not attainable d) Not measurable [L1][CO1]
- Q.13 What part of SMART is missing? This month, the first time my mother asks me to do something, I will do what she asks.
 a) Not Time Bound b) Not Specific enough
 c) Not attainable d) Not measurable [L1][CO1]
- Q.14 For me breakfast is_____best meal of the day.
 a) a b) an
 c) the d) No article [L1][CO2]
- Q.15 _____ children recited_____ poem in_____honour of_____ Prime minister.
 a) the, a, an, a b) a, the, the, the
 c) no article, a, an, the d) the, a, the, the [L1][CO2]
- Q.16 They wanted to hear _____ end of story.
 a) a b) an
 c) the d) No article [L1][CO2]
- Q.17 Which of these must be avoided by the speaker?
 a) He must convey precise information.
 b) He must ensure that the information is understood by the audience.
 c) He must inspire the audience to totally accept his point of view.
 d) He must force the audience to totally accept his point of view. [L1][CO3]
- Q.18 Kabir had already finished the task when his boss_____.
 a) Arrives b) Arrived
 c) Arriving d) None of these [L1][CO2]
- Q.19 It snows in Shimla. (Identify the tense)
 a) Simple Present b) Simple Past
 c) Present Continuous d) Simple Future [L1][CO2]
- Q.20 Radhika always_____ apple jam in her breakfast.
 a) Eat b) Eats
 c) Eating d) Ate [L1][CO2]
- Q.21 My classmates_____practicing. (Put the correct present continuous tense)
 a) is b) are
 c) were d) was [L1][CO2]
- Q.22 Which of these qualities are important in a group discussion?
 a) Emotional stability b) Hostility
 c) Ignorance d) Aggressiveness [L1][CO3]
- Q.23 All the actors and performers _____ in the theatre.

- | | | | |
|------|---|-----------------------------|-----------|
| | a) Are present | b) Is present | |
| | c) Have present | d) had present | [L1][CO2] |
| Q.24 | The way you feel or think about something or someone is known as your. | | |
| | a) Emotions | b) Personality | |
| | c) Genetics | d) Attitude | [L1][CO1] |
| Q.25 | I _____ (write) to her last week. | | |
| | a) wrote | b) has been writing | |
| | c) had been writing | d) written | [L3][CO1] |
| Q.26 | He _____ (be) weak in English in the beginning. | | |
| | a) being | b) been | |
| | c) was | d) had been | [L1][CO1] |
| Q.27 | He _____ (teach) in this college for five years. | | |
| | a) teaches | b) is teaching | |
| | c) taught | d) has been teaching | [L1][CO1] |
| Q.28 | Physics _____ difficult to understand. | | |
| | a) were | b) was | |
| | c) has | d) is | [L3][CO1] |
| Q.29 | Jameson has been assigned to complete an important project using new software. She is afraid that she will be unable to do so. Judy's fear is an example of the _____ attitude component. | | |
| | a) Cognitive | b) Affective | |
| | c) Group | d) Individual | [L3][CO1] |
| Q.30 | In a group discussion, one must communicate with _____. | | |
| | a) Hostility | b) Ignorance | |
| | c) Knowledge | d) long sentences | [L3][CO1] |
| Q.31 | In a group discussion, the discussion must be directed to its logical conclusion. | | |
| | a) True | b) False | [L3][CO1] |
| Q.32 | Which of these must be avoided in a group discussion? | | |
| | a) Speaking facts | b) Asking questions | |
| | c) Speaking fast | d) Speaking with clarity | [L3][CO1] |
| Q.33 | Which of these factors do not enhance listening skills? | | |
| | a) Attention | b) Clear perception | |
| | c) Fakeness | d) Frankness | [L3][CO1] |
| Q.34 | Which of these should be avoided in an interview? | | |
| | a) Clarity | b) Smile | |
| | c) Confusion | d) Confidence | [L2][CO1] |
| Q.35 | Which of these is not a characteristic of a group personality? | | |
| | a) Spirit of conformity | b) Respect for group values | |
| | c) Collective power | d) Disrespect | [L3][CO2] |
| Q.36 | Which of these is the first ingredient in a group discussion? | | |
| | a) Planning | b) Purpose | |
| | c) Informality | d) Leadership | [L3][CO2] |
| Q.37 | Which of these is the greatest means of conveying information? | | |
| | a) Writing | b) Words | |
| | c) Signs | d) Pictures | [L3][CO2] |
| Q.38 | A men's shirt for an interview is | | |
| | a) Long sleeve or short as long as you wear a tie. | | |
| | b) Coordinated with the suit | | |
| | c) Long sleeved that is white | | |

- d) All of the above [L3][CO2]
- Q.39 Diversity and Inclusion are only good for our employees and we do not derive any business advantage from this. Is this statement true?
a) True b) False [L3][CO2]
- Q.40 The Company will provide physical and digital access to all persons with disability within its premises. In a situation where a diverse range of disabilities has a specific access requirement, the company will provide reasonable adjustments.
a) True b) False [L3][CO2]
- Q.41 Diversity and Inclusion well managed do NOT help us to:
a) Better understand our customers.
b) Generate value from creativity and innovation.
c) Provide diverse ideas, opinions, and solutions.
d) None of these. [L3][CO2]
- Q.42 Vivek has joined an organization recently. He identifies as gay but has not come out in the workplace. He notices his team members crack homophobic jokes and use derogatory local terms for effeminate men. Vivek becomes quiet and withdrawn What should he do?
a) Vivek should immediately resign as he is uncomfortable working in such an organization.
b) Vivek should ignore these comments as they are harmless and not directed at him intentionally.
c) Vivek should raise his concern with his supervisor to find a solution.
d) Vivek should fight with the team for his rights. [L3][CO2]
- Q.43 Which of the following statements is/are true?
a) Sexual orientation is defined by an individual's sexual preference defined by the gender he or she is sexually attracted to
b) Addressing sexual orientation as an element of diversity is important to avoid harassment and discrimination
c) Speaking about a person's sexual preference in team meetings promotes team bonding. [L1][CO1]
- Q.44 One of the aspects of inclusion is:
a) Doing what you think is right irrespective of what others say.
b) Encompassing an individual's ideas, perspectives, knowledge, and approach to amplify business success.
c) Ensuring every team member belongs to a different ethnicity.
d) Arranging an office party every Friday. [L1][CO2]
- Q.45 If you notice a breach in the guidelines of the company D&I policy, who can you officially report?
a) Work Friends b) Colleagues
c) Managers/Supervisor d) Security Personnel [L1][CO2]
- Q.46 What does the English language's large vocabulary mean to users?
a) More vowels b) More precise expression
c) More spelling words d) More letters of the alphabet [L1][CO2]
- Q.47 What language is most commonly chosen by international businesses?
a) French b) Japanese
c) Italian d) English [L1][CO2]
- Q.48 When you called, I _____ a shower.
a) Was having b) had
c) am having d) will have [L1][CO2]
- Q.49 If you had arrived late, I _____ angry.
a) had been b) would have
c) would have been d) will have been [L1][CO2]
- Q.50 My family _____ in Australia for a year when I was a child.

a) was living
c) lives

b) will live
d) lived

[L1][CO2]

End Semester Examination, May 2023
B. Design — First Semester
ART AND DESIGN APPRECIATION (BDES-108)

Time: 3 hrs.

Max Marks: **50**

No. of pages: **1**

Note: Attempt **FIVE** questions in all; **Q.1** is **compulsory**. Attempt any **TWO** questions from **PART-A** and **TWO** questions from **PART-B**. Marks are indicated against each question.

- Q.1 Indus valley civilization is known as the oldest for its art and architecture. Mention some examples of the famous masterpieces created during this period and its town planning. [CO1] [L1] **10**

PART-A

- Q.2 During the Maurya dynasty lot of Buddhist art represented its religious images, sculpture, visual mythology and symbols and architecture. Explain in detail few work of art with sketches. [CO2] [L2] **10**
- Q.3 Greek art and the Roman art gave the world its sculpture and architecture. Give few examples of famous artworks of each period. [CO3] [L2] **10**
- Q.4 The most significant frescoes of the ancient and early medieval period are found in the Ajanta caves. Describe in detail some of the famous paintings/ sculptures created during this early medieval period in the Indian history. [CO3] [L2] **10**

PART-B

- Q.5 Indian craft, art of Pichwai paintings and Madhubani paintings are of different style and peiod but has religious motives. Draw any one sample with the help of colors and write in detail about it. [CO4] [L2] **10**
- Q.6 During the renaissance period the great work of arts and architecture was created in the various parts of Europe and other neighboring countries. Menstion some examples of art creations during this period. [CO5] [L2] **10**
- Q.7 Write short notes on (**any two**) of the following:
a) Mandala Art.
b) Tibetan Thangka Painting. [CO5] [L2] **5×2**

End Semester Examination, May 2023

B. Design. — First Semester COLOR THEORY (BDES-109)

Time: 3 hrs.

Max Marks: **50**

No. of pages: **1**

Note: Attempt **FIVE** questions in all; **Q.1** is **compulsory**. Attempt any **TWO** questions from **PART-A** and **TWO** questions from **PART-B**. Marks are indicated against each question.

Q.1 What do different colors symbolize? Discuss about rainbow colors and their meanings. **10**

PART-A

Q.2 What is the difference between primary colors and primary colors of light? Explain in detail with example. [CO1] [L6] **10**

Q.3 What is secondary color in logo? Give example of logo that inspires you. [CO2] [L6] **10**

Q.4 Explain the combination of shapes and colors hold different meanings and moods. [CO3] [L6] **10**

PART-B

Q.5 Who discovered color and how do you explain color theory? Describe in your own words. [CO4] [L6] **10**

Q.6 Discuss the three values of color? Explain with the help of a diagram. [CO5] [L6] **10**

Q.7 a) How to use a split complementary color scheme in design?
b) What is a complementary color scheme? [CO6] [L6] **5×2**

End Semester Examination, May 2023
B. Design — Second Semester
HUMAN ANTHROPOLOGY AND ERGONOMICS (BDES-204)

Time: 3 hrs.

Max Marks: **50**

No. of pages: **1**

Note: Attempt **FIVE** questions in all; **Q.1** is **compulsory**. Attempt any **TWO** questions from **PART-A** and **TWO** questions from **PART-B**. Marks are indicated against each question.

Q.1 Define ergonomics, explain any three applications in detail. [CO1] [L1] **10**

PART-A

Q.2 Explain concept of usability. Define usability in terms of form, feature, function and materials. [CO2] [L2] **10**

Q.3 What is anthropometry? Explain its applications. [CO3] [L3] **10**

Q.4 What are the qualifications of comfort, explain access, reach, posture and movement with examples? [CO4] [L4] **10**

PART-B

Q.5 What is qualification of effort? Explain endurance, strength, physical environment and its impact on human performance. [CO5] [L5] **10**

Q.6 What is static and dynamic effort? Explain in task analysis. [CO6] [L6] **10**

Q.7 What is humanizing design? Explain design and human compatibility. [CO6] [L6] **10**

End Semester Examination, May 2023

B. Design – Second Semester

HUMAN ANTHROPOLOGY AND ERGONOMICS (BDES-204/ BDES-204A)

Time: 2 hrs.

Max Marks: **50**

No. of pages: **1**

Note: Attempt **FIVE** questions in all; **Q.1 is compulsory**. Attempt any **TWO** questions from **PART-A** and **TWO** questions from **PART-B**. Marks are indicated against each question.

Q.1 Define ergonomics, detail any three applications in detail. [CO-1] [L-1] **10**

PART-A

Q.2 Explain Man machine environment system with suitable examples [CO-2] [L-2] **10**

Q.3 Explain bio mechanics and their applications in design [CO-3] [L-3] **10**

Q.4 What are the qualifications of comfort, Explain access, reach, posture and movement with examples? [CO-4] [L-4] **10**

PART-B

Q.5 What is qualification of effort? Explain endurance, strength, physical environment and its impact on human performance. [CO-5] [L-5] **10**

Q.6 Explain the following terms in brief with examples:

- a) Allowance for errors.
- b) Component resilience
- c) Safety against human error.
- d) Safety against feature malfunction

[CO-6] [L-6] **2½×4**

Q.7 What is humanizing design? Explain design and human compatibility. [CO-6] [L-6] **10**

End Semester Examination, May 2023

Bachelor of Design – Second Semester

MEDIA APPRECIATION (BDES 207)

Time: 3 hrs.

Max Marks: **50**

No. of pages: **1**

Note: Attempt **FIVE** questions in all; **Q.1 is compulsory**. Attempt any **TWO** questions from **PART-A** and **TWO** questions from **PART-B**. Marks are indicated against each question.

- Q.1 "Media is an essential part of modern human life." Analyse this statement to trace the evolution of media and the role played by technology in its success. [CO-4][L-6] **10**

PART-A

- Q.2 Analyse the role of director Satyajit Ray in the development of Indian cinema. Evaluate the influence of world cinema in his life. [CO-5][L-4] **10**

- Q.3 How would you go about setting a scene for a horror story? Compare the setting with other two genres to bring out the way cinematography, and sound will differ. [CO-4] [L-3] **10**

- Q.4 A coffee café' has been set up in a college campus. The café is 10'X14' in size. You have been invited to develop a brand design for the same. Create a design and explain in detail. [CO-4][L-5] **10**

PART-B

- Q.5 Write short notes on **(any two)**:
a) Cinematography.
b) Role of sound in film.
c) Editing techniques. [CO-2][L-3] **5×2**
- Q.6 What are the five elements of camera? Differentiate between different camera shots and angles used in film making. [CO-2][L-3] **10**
- Q.7 Create a story board for the promotion of the film terminator - 4. Give the plot details separately and sketch the new suggested protagonist. [CO-4] [L-6] **10**

End Semester Examination, May 2023
B. DESIGN – Second Semester
ART AND DESIGN APPRECIATION-II (BDES-210)

Time: 3 hrs.

Max Marks: **50**

No. of pages: **1**

Note: Attempt **FIVE** questions in all; **Q.1 is compulsory**. Attempt any **TWO** questions from **PART-A** and **TWO** questions from **PART-B**. Marks are indicated against each question.

Q.1 What is culture? Why is it important and discuss the different aspects of culture.

[CO- 1] [L-1] **10**

PART-A

Q.2 Describe the following in a short essay.

Rationalism, Humanism, Germanic art, Dualist, Reasoning

[CO- 2] [L-2] **10**

Q.3 Discuss the two: Age Of reason and age of faith.

[CO-2] [L-2] **10**

Q.4 Discuss the art style of Renaissance and its art. Give examples.

[CO-3] [L-3] **10**

PART-B

Q.5 Discuss colonial Indian art in detail.

[CO-4] [L-4] **10**

Q.6 Describe Islamic architecture. Also discuss Minarets, Domes, and Arches.

[CO-5] [L-5] **10**

Q.7 What is Globalization?

[CO- 6] [L-6] **10**

End Semester Examination, May 2023

B. Design – Fourth Semester FILM STUDIES (BDES-AN-411)

Time: 3 hrs.

Max Marks: **50**

No. of pages: 2

Note: Attempt **FIVE** questions in all; **Q.1 is compulsory**. Attempt any **TWO** questions from **PART-A** and **TWO** questions from **PART-B**. Marks are indicated against each question.

Q.1 **Multiple choice question:**

- a) The Lumiere brothers are known for _____.
 - i) Creating a celluloid film that could capture movement.
 - ii) Inventing a disk that would add sound to movies.
 - iii) Developing the first projector and first movie house.
 - iv) Shooting the first feature-length foreign movie shown in the U.S.
- b) Non-fiction film means _____.
 - i) Artificial ii) Dreams iii) Reality iv) Imagination
- c) The jazz singer film was released in the year of _____.
 - i) 1925 ii) 1926 iii) 1927 iv) 1928
- d) Who developed the first workable motion picture camera?
 - i) Matthew Brady ii) Thomas Edison
 - iii) George Eastman iv) William Dickson
- e) Filmmaking is the process of making a _____ from an initial story idea or commission, through scriptwriting, shooting, editing, directing and distribution to an audience.
 - i) Film editing ii) Film iii) Movie theater iv) Independent Film
- f) What form of comedy do Charlie Chaplin and Buster Keaton share?
 - i) Screwball comedy.
 - ii) Romantic comedy.
 - iii) Slapstick comedy.
 - iv) Their styles were so different that they cannot be compared.
- g) Fantasy films were strong at the turn of the 21st Century because of _____.
 - i) The death of personal cinema. ii) The death of realistic cinema.
 - iii) The emergence of digital effects. iv) Massive economic recession.
- h) Which of these is NOT a fiction?
 - i) Novel ii) Short Stories iii) short Films iv) Auto-biography
- i) Who is the only Indian to have won an Oscar for Lifetime achievement in films?
 - i) V. Shantaram. ii) Raj Kapoor. iii) SubashGhai. iv) Satyajit Ray.
- j) Which of the following are the types of sound in the cinema?
 - i) Loudness, Pitch, Timbre. ii) Speech, Music, Ambient Sound.
 - iii) Rhythm, Fidelity, Space iv) Time, Perspective, Quality. **1×10**

PART-A

- Q.2 What makes a classical Hollywood cinema? Who is the father of classical Hollywood cinema? [CO-1] [L-3] **10**
- Q.3 What were Edison Studios known for producing in early cinema? What were the major differences between films produced by the Edison and the Lumière companies? [CO-2] [L-4] **10**
- Q.4 a) What was The Great Train Robbery most famous for? Discuss. [CO-3] [L-5] **5**
b) The Emergence of the Hollywood studio system. [CO-3] [L-5] **5**

PART-B

- Q.5 What are conventions in film and what is a movie genre? Explain a key difference between genre conventions and other types of storytelling conventions with example. [CO-4] [L-5] **10**
- Q.6 Write short notes on:
a) The Silent Era (1890s-1929).
b) The Golden Age (1930-1950s).
c) What is the plot of The Jazz Singer?
d) 'Diegetic' and 'Non-diegetic' sound.
e) The studio system. [CO-5] [L-6] **2×5**
- Q.7 a) What is CGI computer-generated imagery and how does it work? [CO-6] [L-6] **5**
b) What is digital transmedia? Explain with the help of examples. [CO-6] [L-6] **5**

End Semester Examination, May 2023
B. Design – Fourth Semester
GAME DESIGN AND DOCUMENTATION (BDES-AN-412)

Time: 3 hrs.

Max Marks: **50**

No. of pages: **1**

Note: Attempt **FIVE** questions in all; **Q.1 is compulsory**. Attempt any **TWO** questions from **PART-A** and **TWO** questions from **PART-B**. Marks are indicated against each question.

- Q.1 Discuss the style of following games in context of storytelling and character development: Angry Bird, Counter Strike. **10**

PART-A

- Q.2 What is game design and how it differs from game development? Explain in detail. [CO-1][L-3] **10**
- Q.3 What is a genre in gaming? Differentiate between RTS and RPG games with example. [CO-2][L-4] **10**
- Q.4 Game theory is a fundamental part of game design. Justify your statement in your own words. [CO-3][L-5] **10**

PART-B

- Q.5 a) What is user experience in game design? [CO-5][L-5] **5**
b) Why is character development important in games? [CO-5][L-5] **5**
- Q.6 What is level design and how it differs from environmental art? Analyze the super Mario game in context with the question. [CO-4][L-6] **10**
- Q.7 a) Discuss the most challenging issues of video game design. **5**
b) What is game balance? Distinguish balance in single-player games and balance in asymmetric games. [CO-6] [L-6] **5**

End Semester Examination, May 2023
B. Design – Sixth Semester
STORY BOARDING TECHNIQUES (BDES-AN-604)

Time: 3 hrs.

Max Marks: **50**

No. of pages: **1**

Note: Attempt **FIVE** questions in all; **Q.1 is compulsory**. Attempt any **TWO** questions from **PART-A** and **TWO** questions from **PART-B**. Marks are indicated against each question.

Q.1 Write in detail about the complete process of story boarding. Support with sketch.

[CO-1] [L-1] **10**

PART-A

Q.2 Briefly explain five important elements of a storyboarding.

[CO-2] [L-2] **10**

Q.3 What is a "pipeline" in animation video production?

[CO-3] [L-2] **10**

Q.4 App UX Storyboard: why you should have a story board for an app and how it's going to help the designers as well as the users?

[CO-3] [L-2] **10**

PART-B

Q.5 Visualize the future video without building it. Explain the process in points

[CO-4] [L-2] **10**

Q.6 Onomatopoeia is when a word sounds like the noise it is describing. Comics often use onomatopoeia to show sound effects. How it's used in story board?

[CO-5] [L-2] **10**

Q.7 Write short notes on **(any two)** of the following:

- a) Ariel view.
- b) Horizontal view (drone photography).
- c) Ants view.

[CO-5] [L-2] **5×2**

End Semester Examination, May 2023

B. Design – Sixth Semester

FILM DIRECTION STUDIES (BDES-AN-605)

Time: 3 hrs.

Max Marks: **50**

No. of pages: **1**

Note: Attempt **FIVE** questions in all; **Q.1 is compulsory**. Attempt any **TWO** questions from **PART-A** and **TWO** questions from **PART-B**. Marks are indicated against each question.

Q.1 Multiple choice question:

- a) Which is the first serialized animation film in India?
 - i) Ek Anek aur Ekta
 - ii) Ghayab Aya
 - iii) Kittu
 - iv) Motu Patlu

- b) In which stage are ideas for a film generated?
 - i) Pre-production stage
 - ii) Production stage
 - iii) Development stage
 - iv) Post-production stage
- c) Which one of these is not a component of film?
 - i) Script
 - ii) Acting
 - iii) Movie launch
 - iv) Editing
- d) A written work by screenwriters for a film is called _____.
 - i) Screenplay
 - ii) Teleplay
 - iii) Storyboard
 - iv) Press release
- e) Which among them is not type of lighting?
 - i) One-point lighting
 - ii) Ni-directional light
 - iii) Two-point lighting
 - iv) Three-point lighting
- f) Mise-en-scene means in French.
 - i) Close shot
 - ii) Placing on stage
 - iii) Sequence
 - iv) Video-making
- g) Akira Kurosawa was a _____ filmmaker.
 - i) South Korean
 - ii) Japanese
 - iii) English
 - iv) Indian
- h) Who is known as "The master of storytelling"?
 - i) Satyajit Ray
 - ii) Ritvik Ghatak
 - iii) Akira Kurosawa
 - iv) Orson Welles
- i) Who acted as the main lead in Mother India?
 - i) Nargis
 - ii) Sharmila Tagore
 - iii) Madhubala
 - iv) Sri Devi
- j) Which among the following is an element of film?
 - i) Camera Angle
 - ii) Editing
 - iii) Sound
 - iv) All of the above

1×10

PART-A

- Q.2 How do you describe a film director? Discuss the responsibilities of a film director in your words. [CO-1][L-3] **10**

- Q.3 What does the director of an animated movie do? Discuss about any one filmmaker who is most associated with animation. [CO-2][L-4] **10**

- Q.4 Which part slows down the pace of the narrative? How do you slow down the pace of a scene? [CO-3][L-5] **10**

PART-B

- Q.5 What is the difference between a screenplay and a script? Give example. [CO4][L-5] **10**

- Q.6 Define the following terms:
 - a) The dope sheet
 - b) Exposure charts
 - c) Staging
 - d) Rehearsal Schedules
 - e) storyboard

[CO-5][L-6] **10**

Q.7 There are five phases of film production and they include development, pre-production, production, post-production and distribution. Discuss in detail. [CO-6] [L-6] **10**

End Semester Examination, May 2023
B. Sc. (Interior Design) — First Semester
HARD MATERIAL AND FINISHES (BID-DS-105)

Time: 3 hrs.

Max Marks: **50**

No. of pages: **1**

Note: Attempt **FIVE** questions in all; **Q.1** is **compulsory**. Attempt any **TWO** questions from **PART-A** and **TWO** questions from **PART-B**. Marks are indicated against each question.

- Q.1 Discuss the various types of wood and seasoning methods. List the use of laminate and veneer. [CO1] [L1] **10**

PART-A

- Q.2 Demonstrate the methods to calculate the budget estimate, their quantities and pricing for the renovation of the drawing /dining hall for a residential apartment. Client wishes to use wall paper on one wall and rest paint. In which units will you take out the quantities? [CO2] [L2] **10**
- Q.3 Suggest the use of bamboo in interiors. Why is bamboo preferred over other materials in many areas? [CO3] [L3] **10**
- Q.4 Prepare a proposal for the finishes of a interiors of a luxury villa in Delhi. Specify the composition of various materials for flooring, wall finishes, and wood work. How does location and climate affect the choice of materials? [CO4] [L4] **10**

PART-B

- Q.5 Write short notes on the following:
a) Types of wall coverings, with reference to paints.
b) Use of leather and suede in interiors.
c) Use of bamboo and bamboo mat tiles.
d) Sustainable green building practices in interiors. [CO5] [L5] **2½×4**
- Q.6 Explain the characteristics and properties of stone and brick, as a building material for interior and exterior purposes. [CO6] [L6] **10**
- Q.7 What are eco friendly materials? Recommend few interior materials that will make less impact on the environment and can be used for interiors. Name three green materials used in interiors. [CO6] [L6] **10**

End Semester Examination, May 2023
B. Sc. (Interior Design) — Second Semester
HISTORY OF FURNITURE AND DECORATION-II (BID-DS-203)

Time: 3 hrs.

Max Marks: **50**

No. of pages: **1**

Note: Attempt **FIVE** questions in all; **Q.1** is **compulsory**. Attempt any **TWO** questions from **PART-A** and **TWO** questions from **PART-B**. Marks are indicated against each question.

Q.1 Explain the evolution of Indian furniture. **10**

PART-A

Q.2 What is the difference between the furniture style of 18th and 19th century? [CO1] [L1] **10**

Q.3 Explain Modern Victorian era in detail. [CO2] [L2] **10**

Q.4 Illustrate the design of furniture pieces of neoclassical style and Victorian style. [CO3] [L3] **10**

PART-B

Q.5 Write in detail about the famous designers from the two schools of thoughts mentioned below and explain how they were major force in developing the concepts and laying the foundations of Industrial design?

- a) Ludwig Mies Van Der Rohe
- b) Marcel Breuer

[CO4] [L4] **10**

Q.6 Explain briefly about the minimalistic style furniture. Give examples of various furniture styles of different periods supporting the style along with neat sketches. [CO5] [L5] **10**

Q.7 Discuss the social & economic reasons furniture construction changes over the decades. [CO6] [L6] **10**

End Semester Examination, May 2023
B. Sc. (Interior Design) — Second Semester
WINDOW TREATMENT AND ACCESSORIES (BID-DS-204)

Time: 3 hrs.

Max Marks: **50**

No. of pages: **1**

Note: Attempt **FIVE** questions in all; **Q.1 is compulsory**. Attempt any **TWO** questions from **PART-A** and any **TWO** questions from **PART-B**. Marks are indicated against each question.

- Q.1 Define the term 'window treatment'. Discuss In detail tike factors to be kept in mind, while selecting treatments for a window. **10**

PART-A

- Q.2 Discuss in detail various types of window treatments with the help of a flow chart along with suitable pictorial representation. [CO1] [L1] **10**
- Q.3 How can different period styles of window treatment be coordinated with interior design? Give suitable examples. [CO2] [L2] **10**
- Q.4 Treating a window is the most important part in interior design. Discuss in detail the importance of treating a window with suitable example. [CO3] [L3] **10**

PART-B

- Q.5 Define the term 'Pleat'. Discuss the different types of cleats with suitable examples. [CO4] [L4] **10**
- Q.6 Explain 'curtains'. Explain with the help of sketches also. Describe at least two different types/styles of soft curtains. [CO5] [L5] **10**
- Q.7 Blinds plays an important role in treating a window. Discuss various types of blinds along with their uses in interior design. [CO6] [L6] **10**

End Semester Examination, May 2023
B. Sc. (Interior Design) — Second Semester
SOFT MATERIAL AND FINISHES (BID-DS-205)

Time: 3 hrs.

Max Marks: **50**

No. of pages: **1**

Note: Attempt **FIVE** questions in all; **Q.1** is **compulsory**. Attempt any **TWO** questions from **PART-A** and any **TWO** questions from **PART-B**. Marks are indicated against each question.

- Q.1 What is the difference between natural and synthetic fabric? Discuss the different methods of fabric construction and how we utilize different varieties of fibre in it?
[CO1] [L1] **10**

PART-A

- Q.2 Explain any five fabrics with their pros and cons in detail. [CO2] [L2] **10**
- Q.3 What factors one should keep in mind while selecting the textile for a site?
[CO3][L3] **10**
- Q.4 Examine the performance of different weaves of fabric and patterns in carpets.
[CO4] [L4] **10**

PART-B

- Q.5 Explain all the soft furnishings required in an interior space and their importance in interior.
[CO5] [L5] **10**
- Q.6 Explain the environmental impact created when specifying specific types of fibers.
[CO6] [L6] **10**
- Q.7 Discuss textiles from different cultures based on composition, manufacturing processes and weaving techniques used.
[CO6] [L6] **10**

End Semester Examination, May 2023

B. Sc. (Interior Design) – Second Semester

COMMUNICATION – II (BID-DS-206)

Time: 2 hrs.

Max Marks: 50

No. of pages: 5

Note: All questions are compulsory. Each question has **FOUR** options with **ONE** correct answer. Select the correct answer. All questions are of **ONE** mark each. There is no **NEGATIVE** marking. Mention the correct option for each question in the blank answer key given herein below. Calculator is not permitted.

1.	2.	3.	4.	5.	6.	7.	8.	9.	10.
11.	12.	13.	14.	15.	16.	17.	18.	19.	20.
21.	22.	23.	24.	25.	26.	27.	28.	29.	30.
31.	32.	33.	34.	35.	36.	37.	38.	39.	40.
41.	42.	43.	44.	45.	46.	47.	48.	49.	50.

Directions of questions from Q.1 to Q.3 questions: Read the passage and find correct answers:

First language, also known as mother tongue, is generally the language a person learns first. However, one can have two or more native languages thus being a native bilingual or indeed multilingual. The order in which these languages are learned is not necessarily the order of proficiency. Lacking in first language skills often make learning other languages difficult. Often a child learns the basics of his or her first language or languages from his or her family. The term mother tongue, however, should not be interpreted to mean that it is the language of one's mother. For instance, in some paternal societies, the wife moves in with the husband and thus may have a different first language or dialect than the local language of the husband. Yet their children usually only speak their local language.

- Q.1 According to the passage, first language skills ----. [CO-1] [L-1]
a) take a very long time to develop
b) play an important role in learning a new language
c) are not transferable to the second language
d) can also have negative effects in foreign language acquisition
- Q.2 We understand from the passage that ----. [CO-1] [L-1]
a) most bilinguals don't have a dominant language
b) the acquisition of a first language is the most complex skill anyone ever learns
c) most children have learning difficulties in acquiring their first language
d) one's mother tongue might not be the language of the parents
- Q.3 One can infer from the reading that ----. [CO-1] [L-1]
a) one cannot be a native speaker of more than two languages
b) very few children throughout the world learn to speak two languages
c) it is possible for a bilingual to become more competent in his second language
d) bilinguals use their two languages for different purposes and functions
- Q.4 When giving a presentation in front of an audience you should do all of the following except for: [CO-2] [L-1]
a) Speak loud and clear
b) Provide handouts if needed
c) Dress professionally
d) Look at your screen and not the audience
- Q.5 Why should you keep text to a minimum on slides? [CO-2] [L-1]
a) So the focus is on you as the speaker
b) To help make your presentation longer
c) So the pictures are easier to see
d) To make sure the audience can read everything you have to tell them

- Q.6 Your presentation should consist of title slide, _____, body, and _____. [CO-2][L-1]
 a) objects and summary b) opinions and paragraphs
 c) objectives and summary d) options and pages
- Q.7 Choose the correct Preposition: This is a letter _____ Uncle Tom. [CO-3] [L-2]
 a) from b) in
 c) by d) at
- Q.8 Choose the correct Preposition: I've got a problem _____ my homework. Can you help me please? [CO-3] [L-2]
 a) at b) of
 c) with d) in
- Q.9 Complete the sentence with correct answer: If he comes, _____. [CO-3] [L-2]
 a) we will go to lunch b) we would go to lunch
 c) we went to lunch d) we would have gone to lunch
- Q.10 Complete the sentence with correct answer: I would buy a new house _____. [CO-3] [L-2]
 a) if I have a lot of money b) if I win the lottery.
 c) if I inherited a million dollars. d) if I had won a million dollars.
- Q.11 Which distance are you using if you are talking to someone across the street? [CO-2] [L-1]
 a) Intimate b) Personal
 d) Social d) Public
- Q.12 _____ is the term used to describe the study of how humans use and structure time. [CO-2] [L-1]
 a) proxemics b) paralanguage
 c) haptics d) chronemics
- Q.13 Meeting deadlines is very important to us in job. Sentence defines which term: [CO2] [L1]
 a) Chronemic b) Working culture
 c) Kinesics d) Proxemics
- Q.14 Why must a public speaker be audience-centered? [CO-2] [L-1]
 a) So that people like you better.
 b) So that you can seem tough in front of your audience.
 c) So that you can keep your audience interested.
 d) So that you can help other people out.
- Q.15 How can you get information about an audience? [CO-2] [L-1]
 a) Talking and observing them.
 b) There isn't a way to get information about an audience you just have to guess.
 c) Look at their reactions at specific topics
 d) Asking someone they know
- Q.16 What can you use to adapt your speech to your audience BEFORE the speech? [CO-2] [L-1]
 a) Keep your audience in mind. b) Nothing.
 c) Talking to your audience. d) Putting questions in speech.
- Q.17 In presentation, what is ABCD? [CO-2] [L-1]
 a) Any Body Can Direct
 b) Audience, Balance, Counting, Direction
 c) Assessment before count directions
 d) Attention, Benefits, Credibility, Direction

Directions of questions from Q.18 to Q.20 questions: Read the passage and find correct answers:

Much of the blood on the street flows essentially from uncivil behaviour of drivers who refuse to respect the legal and moral rights of others. So, the massacre on the road may be regarded as a social problem. Safety standards for vehicle have been raised both at the point of manufacture and through periodic road-worthiness inspections. In addition, speed limits

have been lowered. Due to these measures, the accident rate has decreased. But the accident experts still worry because there has been little or no improvement in the way drivers behave.

Q.18 According to the passage, traffic accidents may be regarded as a social problem since [CO-1] [L-1]

- a) the motor vehicle is a very dangerous invention
- b) the accidents have more to do with hazardous conditions than hazardous drivers
- c) most of the accidents are caused by drivers who don't pay attention to the traffic rules
- d) the irresponsibility that accounts for much of the problem is not confined to drivers

Q.19 According to the passage, the number of accidents has fallen because ----. [CO-1] [L-1]

- a) significant advances have been made towards safer driving
- b) many people now know that driving is a skilled task requiring constant care and concentration
- c) drivers are warned to take extra care on the roads
- d) drivers have finally learned how to behave

Q.20 It is pointed out in the passage that those who violate traffic regulations ----. [CO-1] [L-1]

- a) are the most inexperienced drivers that we have on the roads
- b) always blame the road conditions
- c) don't have prior traffic violations or crashes on their records
- d) are the biggest threat to those with whom they share the road

Q.21 What is the main purpose of the narrative paragraph? [CO-1] [L-2]

- a) Inspire the reader to feel a certain way towards an event, character, place, etc.
- b) Explain a concept in full depth.
- c) Make the reader experience whatever is narrated.
- d) The purpose is to tell stories

Q.22 What is a descriptive paragraph? [CO-1] [L-2]

- a) Text describing a person, animal, place, or thing, along with idea and theme.
- b) Tell a story to the reader.
- c) Give your opinion to the reader.
- d) Explaining a concept or idea.

Q.23 The main point of this passage is that... [CO-1] [L-3]

Carbon tetrachloride is a colourless and inflammable liquid that can be produced by combining carbon disulfide and chlorine. This compound is widely used in industry today because of its effectiveness as a solvent as well as its use in the production of propellants. Despite its widespread use in industry, carbon tetrachloride has been banned for home use. In the past, carbon tetrachloride was a common ingredient in cleaning compounds that were used throughout the home, but it was found to be dangerous: when heated, it changes into a poisonous gas that can cause severe illness and even death if it is inhaled. Because of this dangerous characteristic, the United States revoked permission for the home use of carbon tetrachloride in 1970. The United States has taken similar action with various other chemical compounds.

- a) Carbon tetrachloride can be very dangerous when it is heated.
- b) The government banned carbon tetrachloride in 1970
- c) Although carbon tetrachloride can legally be used in industry, it is not allowed in-home products.
- d) Carbon tetrachloride used to be a regular part of cleaning compounds

Question 24 and 25: Read the following sentences and try to choose the best definition for the italicized word by searching for context clues in the sentence.

Q.24 Excited about winning the award, Marcia walked up to the podium and delivered an animated acceptance speech. [CO-1] [L-3]

- a) abbreviated b) courteous
c) reserved d) lively
- Q.25 The doctor got to the crux of the issue. [CO-1] [L-3]
a) outline b) opposite
c) crucial point d) unhealthy
- Q.26 If you wanted to find out why sales are down at your company, what type of report would you write. [CO-1] [L-2]
a) a crime report b) a problem-solving report
c) an evaluation study d) a proposal
- Q.27 Who writes reports? [CO-1] [L-2]
a) Business managers b) Company owners
c) Department supervisors d) All of the above
- Q.28 What does orderly means in report writing? [CO-1] [L-2]
a) persuasive b) carefully prepared
c) fact-based d) objective
- Q.29 Which of the following should your notes include? [CO-1] [L-2]
a) key words and phrases b) complete sentences
c) full paragraphs c) exact punctuation
- Q.30 What is summarizing in note taking? [CO-1] [L-2]
a) Restating in your own words only the key ideas of the original piece in a condensed form
b) Copying the ideas word for word and using quotation marks
c) Restating the content in your own words by replacing some of the words to avoid plagiarizing but maintaining most of the same meaning
d) Writing the first and last sentence of every paragraph
- Q.31 Please select the correct statement [CO-3] [L-2]
a) He passed out of college in 1997
b) He passed out college in 1997
c) He passed college in 1997
d) He graduated college in 1997
- Q.32 Select the correct statement. [CO-3] [L-2]
a) I have one query to ask you b) I have a query
c) I have a one query d) I have the query
- Q.33 Choose the answers for First conditional: If he (run) he (get) there in time. [CO-3] [L-2]
a) will run; get b) runs; will get
c) run; will get d) will run; will get
- Q.34 Choose the correct verb: if it (stop) snowing, we can go skiing. [CO-3] [L-2]
a) stops b) will stop
c) will stops d) stop
- Q.35 Choose the correct verb: If they had not _____ the car, I would have driven you. [CO-3] [L-2]
a) take b) taken
c) would take d) took
- Q.36 Choose the correct verb: Angel will move this table to another place if you _____ her house tomorrow. [CO-3] [L-2]
a) Comes to b) Come to
c) Came to d) Came
- Q.37 Choose the correct verb: My mother would not go to my uncle's house if my uncle _____ my mother's call. [CO-3] [L-2]
a) Had received b) Received
c) Receives d) Receive
- Q.38 Choose the correct preposition: He has been absent ____ Monday. [CO-3] [L-2]
a) For b) Since
c) From d) All of the above

- Q.39 Choose the correct preposition: They are called ____ different names. [CO-3] [L-2]
 a) With b) By
 c) For d) From
- Q.40 Choose the correct preposition: The new term begins ____ June 1st. [CO-3] [L-2]
 a) On b) In
 c) At d) From
- Q.41 Choose the correct preposition: He poured the tea ____ the mug. [CO-3] [L-2]
 a) In b) Into
 c) On d) Onto
- Q.42 Choose the correct preposition: He said he was very pleased ____ my work. [CO-3] [L-2]
 a) With b) In
 c) At d) From
- Q.43 Choose the correct preposition: "I really care ____ what happens to him." [CO-3] [L-2]
 a) of b) about
 c) at d) to
- Q.44 Choose the correct preposition: "I heard that he died ____ a heart attack." [CO-3] [L-2]
 a) to b) of
 c) for d) about
- Q.45 Choose the type of conditional: "He would have gone with you if you had asked him." Which conditional is this? [CO-3] [L-2]
 a) Zero b) first
 c) second d) third
- Q.46 This is the first thing people judge. [CO-2] [L-1]
 a) chronemics b) proxemics
 c) pitch d) physical appearance
- Q.47 Justin speaks so fast his brothers cannot understand him. He needs to adjust his ... [CO-2] [L-1]
 a) voice quality b) haptics
 c) rate of speech d) intonation
- Q.48 The five types of nonverbal communication are... [CO-2] [L-1]
 a) gestures, posture, standing, adaptors, and eye contact.
 b) kinesics, paralanguage, proxemics, chronemics, and voice.
 c) space, rate of speech, voice, and appearance, eye contact.
 d) body, voice, space, time, and appearance.
- Q.49 _____ refers to how space and distance communicate. [CO-2] [L-1]
 a) Kinesics b) Proxemics
 c) Paralanguage d) Chronemics
- Q.50 According to the text, the use of your body to communicate non-verbally is referred to as... [CO-2] [L-1]
 a) vocalic b) proxemics
 c) kinesics d) chronemics